

**vtech**<sup>®</sup>

**User's Manual**

# **Monkey Moves Smart Seat™**



© 2009 VTech

Made in China

91-002399-000-000 

Dear Parent,

Ever notice the look on your baby's face when they learn something new through their own discovery? These self-accomplished moments are a parent's greatest reward. To help fulfill them, **VTech**<sup>®</sup> created the **Jungle Gym**<sup>®</sup> series of toys.

These unique interactive learning toys directly respond to what children do naturally – play! Using innovative technology, these toys react to baby's interactions, making each play experience fun and unique as they learn age-appropriate concepts like first words, numbers, shapes, colors and music. More importantly, **VTech**<sup>®</sup>'s **Jungle Gym**<sup>®</sup> toys develop baby's mental and physical abilities by inspiring, engaging and teaching.

At **VTech**<sup>®</sup>, we know that a child has the ability to do great things. That's why all of our electronic learning products are uniquely designed to develop a child's mind and allow them to learn to the best of their ability. We thank you for trusting **VTech**<sup>®</sup> with the important job of helping your child learn and grow!

Sincerely,

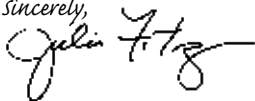

Julia Fitzgerald  
Vice President, Marketing  
Vtech Electronics, NA

To learn more about the **Jungle Gym**<sup>®</sup> series and other **VTech**<sup>®</sup> toys, visit [www.vtechkids.com](http://www.vtechkids.com)

# INTRODUCTION

Thank you for purchasing the **VTech® Monkey Moves Smart Seat™** learning toy!

Get ready to monkey around with the **Monkey Moves Smart Seat™**. This adorable monkey loves to play by moving his arms up and down -- the more they move, the more your child learns. Active play is rewarded with fun melodies, animal sounds, dancing lights and a pop-up baby monkey. Complete with a sturdy sliding seat, the fun grows as baby grows!

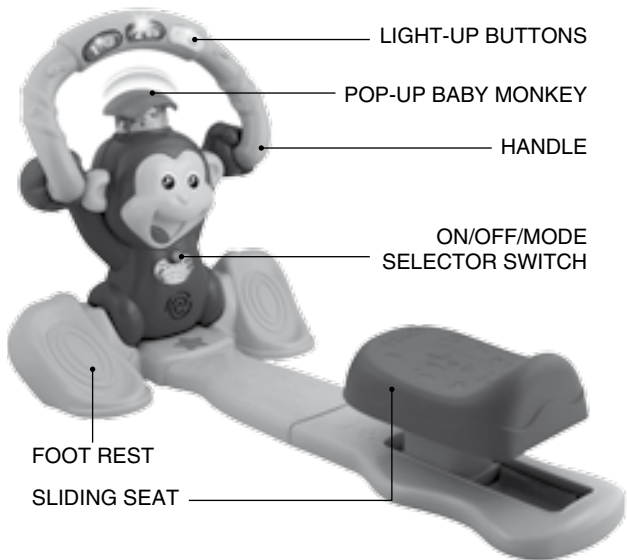

# INCLUDED IN THIS PACKAGE

- One VTech® Monkey Moves Smart Seat™

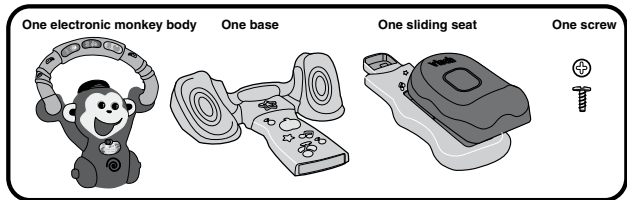

- One instruction manual

**WARNING:** All packing materials, such as tape, plastic sheets, wire ties, screw and tags are not part of this toy, and should be discarded for your child's safety.

## GETTING STARTED

### BATTERY INSTALLATION

1. Make sure the unit is turned **OFF**.
2. Locate the battery cover on the back of the unit. Use a coin or a screwdriver to loosen the screw.
3. Install 3 new 'AA' batteries following the diagram inside the battery box. (The use of new alkaline batteries is recommended for maximum performance.)
4. Replace the battery cover and tighten the screw to secure.

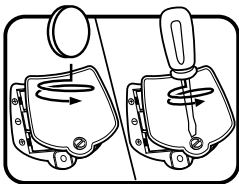

## BATTERY NOTICE

- Install batteries correctly observing the polarity (+, -) signs to avoid leakage.
- Do not mix old and new batteries.
- Do not mix batteries of different types: alkaline, standard (carbon-zinc) or rechargeable (nickel-cadmium).
- Remove the batteries from the equipment when the unit will not be used for an extended period of time
- Always remove exhausted batteries from the equipment.
- Do not dispose of batteries in fire.
- Do not attempt to recharge ordinary batteries.
- The supply terminals are not to be short-circuited.
- Only batteries of the same and equivalent type as recommended are to be used.

## WE DO NOT RECOMMEND THE USE OF RECHARGEABLE BATTERIES.

With the **VTech® Monkey Moves Smart Seat™**, safety comes first. To ensure your child's safety, please only assemble this product by an adult.

## ASSEMBLY

1. Insert the end of the sliding seat into the slot on the end of the base and then tighten the screw to secure.

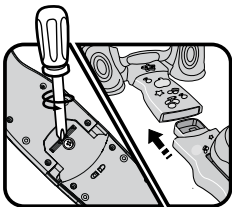

2. Insert the electronic monkey body into the recessed area of the base. Once the body is securely in place, you will hear a click.



## DISASSEMBLY

1. Locate the snap locks on the sides of the base. Push in the locks from both sides while simultaneously pulling the monkey out of the base.
2. Turn the base over and locate the tabs on the bottom, which are securing the seat to the base. Use a screwdriver to loosen the screw, then pull the sliding seat away from the base to detach it.

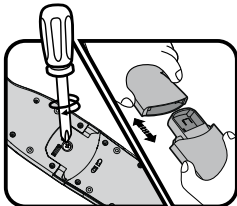
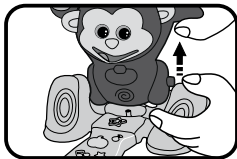

**ATTENTION:** The maximum weight limit for this product is 42 pounds. It is not recommended for children older than 36 months.

## PRODUCT FEATURES

### 1. ON/OFF/MODE SELECTOR SWITCH

To turn the unit **ON**, slide the **ON/OFF/MODE SELECTOR SWITCH** to the **Learning Mode** (1,2,3) or the **Music Mode** (🎵) position. To turn the unit **OFF**, slide the **ON/OFF/MODE SELECTOR SWITCH** to the **Off** (●) position.

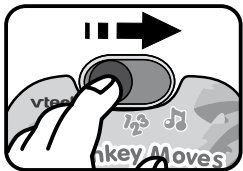

## 2. AUTOMATIC SHUT-OFF

To preserve battery life, the **VTech® Monkey Moves Smart Seat™** will automatically power-down after approximately 24 seconds without input. The unit can be turned on again by pressing any button.

### ACTIVITIES

1. Slide the **ON/OFF/MODE SELECTOR SWITCH** to turn the unit **ON**. You will hear fun sounds, a song and an encouraging phrase. The lights will flash with the sounds, and the baby monkey will pop up to surprise you!
2. Press the **LIGHT-UP BUTTONS** to hear fun sounds, phrases, short tunes and melodies. In Learning Mode, pressing the buttons will teach colors and fruit. In Music Mode, pressing the buttons will play melodies and fun sounds. The lights will flash with the sounds.
3. Move the **MONKEY BODY** forward and backward to hear fun sounds, phrases, activate games, sing-along songs and melodies. In Learning Mode, you'll be asked to move the monkey body to find a fruit. Keep moving until the desired fruit button lights up. In Music Mode, moving the monkey body activates fun sounds, melodies and sing-along songs. While a melody is playing, press the light-up buttons to jam fun sounds on top of the melody. Moving the monkey body faster and faster will make the melody play faster and will jam fun sounds.

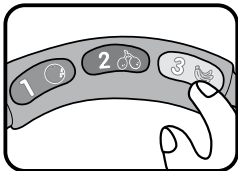
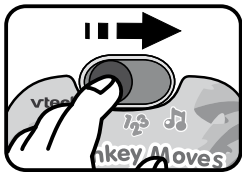

4. Press the **BABY MONKEY** down to hear a monkey sound. The lights will flash with the sounds.

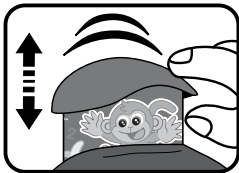

5. If there is no input for approximately 5 seconds while the baby monkey is popped up, you will hear a fun sound and a reminding phrase. If there continues to be no input after another 3 seconds, you will hear a fun sound and a phrase or a melody. If there continues to be no input after another 8 seconds, you will hear a fun sound and a song. If there continues to be no input after another 8 seconds, you will hear “See ya soon!” and the unit will automatically power down. The unit can be turned on again by pressing any button.

### **MELODY LIST:**

1. Row, Row, Row Your Boat
2. Here We Go ‘Round the Mulberry Bush
3. The Aba Daba Honeymoon
4. It's Raining, It's Pouring
5. The Glow Worm
6. Teddy Bears' Picnic
7. Pop Goes the Weasel

### **SUNG SONG 1 LYRICS**

Come along with me,  
Swinging through the trees.  
Meet new jungle friends –  
Fun that never ends!



## SUNG SONG 2 LYRICS

Move your arms, forward and back.

Try again, now, you've got the knack!

## CARE & MAINTENANCE

1. Keep the unit clean by wiping it with a slightly damp cloth.
2. Keep the unit out of direct sunlight and away from any direct heat source.
3. Remove the batteries when the unit will not be in use for an extended period of time.
4. Do not drop the unit on hard surfaces and do not expose the unit to moisture or water.

## TROUBLESHOOTING

If for some reason the program/activity stops working or malfunctions, please follow these steps:

1. Please turn the unit **OFF**.
2. Interrupt the power supply by removing the batteries.
3. Let the unit stand for a few minutes, then replace the batteries.
4. Turn the unit **ON**. The unit should now be ready to play again.
5. If the product still does not work, replace with an entire set of new batteries.

If the problem persists, please call our Consumer Services Department at 1-800-521-2010 in the U.S. or 1-877-352-8697 in Canada, and a service representative will be happy to help you.

For information on this product's warranty, please call our Consumer Services Department at 1-800-521-2010 in the U.S. or 1-877-352-8697 in Canada.

## **IMPORTANT NOTE:**

Creating and developing **Active Play** products is accompanied by a responsibility that we at **VTech®** take very seriously. We make every effort to ensure the accuracy of the information, which forms the value of our products. However, errors sometimes can occur. It is important for you to know that we stand behind our products and encourage you to call our Consumer Services Department at 1-800-521-2010 in the U.S. or 1-877-352-8697 in Canada, with any problems and/or suggestions that you might have. A service representative will be happy to help you.

### **Note:**

This equipment has been tested and found to comply with the limits for a Class B digital device, pursuant to Part 15 of the FCC Rules. These limits are designed to provide reasonable protection against harmful interference in a residential installation. This equipment generates, uses and can radiate radio frequency energy and, if not installed and used in accordance with the instructions, may cause harmful interference to radio communications. However, there is no guarantee that interference will not occur in a particular installation. If this equipment does cause harmful interference to radio or television reception, which can be determined by turning the equipment off and on, the user is encouraged to try to correct the interference by one or more of the following measures:

- Reorient or relocate the receiving antenna
- Increase the separation between the equipment and receiver
- Connect the equipment into an outlet on a circuit different from that to which the receiver is connected
- Consult the dealer or an experienced radio/TV technician for help

THIS DEVICE COMPLIES WITH PART 15 OF THE FCC RULES. OPERATION IS SUBJECT TO THE FOLLOWING TWO CONDITIONS: (1) THIS DEVICE MAY NOT CAUSE HARMFUL INTERFERENCE, AND (2) THIS DEVICE MUST ACCEPT ANY INTERFERENCE RECEIVED, INCLUDING INTERFERENCE THAT MAY CAUSE UNDESIRE OPERATION.

THIS CLASS B DIGITAL APPARATUS COMPLIES WITH CANADIAN ICES-003.

CET APPAREIL NUMÉRIQUE DE LA CLASSE B EST CONFORME À LA NORME NMB-003 DU CANADA.

**Caution:** Changes or modifications not expressly approved by the party responsible for compliance could void the user's authority to operate the equipment.