

vtech®

Instruction Manual

TWIST ADVENTURES™

Dino Discoveries



INTRODUCTION

Thank you for purchasing the **Twist Adventures™ Dino Discoveries!** Elevate your fidget fun all while learning about dinosaurs and other prehistoric creatures! Twist and turn to get the right dino lined up, then press to discover some great dino facts.

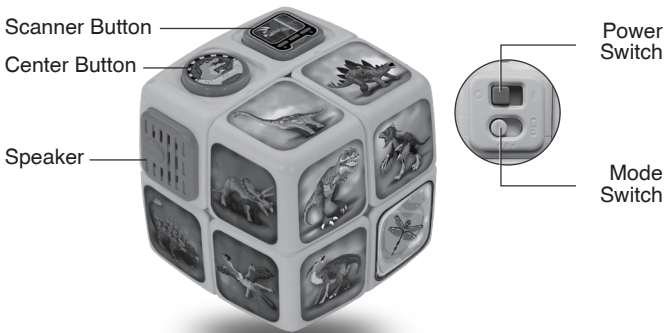

INCLUDED IN THE PACKAGE

- **Twist Adventures™ Dino Discoveries Cube**
- Mini Dino Field Guide
- Quick Start Guide

WARNING

All packing materials such as tape, plastic sheets, packaging locks, removable tags, cable ties, cords and packaging screws are not part of this toy, and should be discarded for your child's safety.

NOTE

Please save this Instruction Manual as it contains important information.

ATTENTION

Pour la sécurité de votre enfant, débarrassez-vous de tous les produits d'emballage tels que rubans adhésifs, feuilles de plastique, attaches, étiquettes, cordons et vis d'emballage. Ils ne font pas partie du jouet.

NOTE

Il est conseillé de sauvegarder ce manuel d'utilisation car il comporte des informations importantes.

Unlock the Packaging Locks

- ① Rotate the packaging locks 90 degrees counterclockwise.
- ② Pull out the packaging locks and discard.

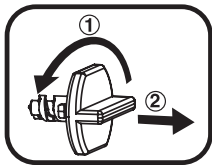

GETTING STARTED

Battery Removal and Installation

1. Make sure the unit is turned **Off**.
2. Locate the battery cover on the back of each unit, use a screwdriver to loosen the screw and open the battery cover.
3. Remove old batteries by pulling up on one end of each battery.
4. Install 2 new AAA (AM-4/LR03) batteries into each unit following the diagram inside the battery box. (For best performance, alkaline batteries or fully charged Ni-MH rechargeable batteries are recommended.)
5. Replace the battery cover and tighten the screw to secure.

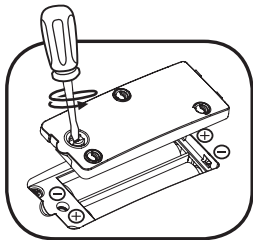

IMPORTANT: BATTERY INFORMATION

- Insert batteries with the correct polarity (+ and -).
- Do not mix old and new batteries.
- Do not mix alkaline, standard (carbon-zinc) or rechargeable batteries.
- Only batteries of the same or equivalent type as recommended are to be used.
- Do not short-circuit the supply terminals.
- Remove batteries during long periods of non-use.
- Remove exhausted batteries from the toy.
- Dispose of batteries safely. Do not dispose of batteries in fire.

RECHARGEABLE BATTERIES

- Remove rechargeable batteries (if removable) from the toy before charging.
- Rechargeable batteries are only to be charged under adult supervision.
- Do not charge non-rechargeable batteries.



WARNING:

Adult assembly required for battery installation.
Keep batteries out of reach of children.



ATTENTION :

Les piles ou accumulateurs doivent être installés par un adulte.
Tenir les piles ou accumulateurs hors de portée des enfants.

PRODUCT FEATURES

1. Power Switch

To turn the cube On, slide the Power Switch to the On position.
To turn the cube Off, slide the Power Switch to the Off position.

2. Mode Switch

Slide the Mode Switch to different position to choose from 3 modes to play: Discovery, Mission or Challenge.

3. Buttons

The Buttons will light up to indicate game responses.
Press the glowing Button as instructed during game play.

4. Automatic Shut-Off



When idle for 1.5 minutes the **Twist Adventures™ Dino Discoveries** Cube will turn off automatically to conserve battery life. The cube can be turned on again by pressing any button.

ACTIVITIES

1. Discovery

This is a free discovery mode. Move a picture to align with a zone and press the button to hear fun facts about dinosaurs and fossils.

2. Mission

Start your adventure in the Dino Zoo. Follow the clues to find the dinosaur and scan them with the Dino Scanner Button . In the special event, follow the clues and bring the escaped dinosaur back to the Dino Center .

3. Challenge

This is a timed challenge game. A specific dinosaur or fossil will be named. Twist to move that face to align with the glowing zone. Press the glowing button to confirm your answers. See how many matches you can make in a limited time and see if you can earn three stars.

CARE & MAINTENANCE

1. Keep the units clean by wiping them with a slightly damp cloth.
2. Keep the units out of direct sunlight and away from any direct heat sources.
3. Remove the batteries if the units will not be in use for an extended period of time.
4. Do not drop the units on hard surfaces and do not expose the units to moisture or water.

TROUBLESHOOTING

If a unit loses connection, stops working or malfunctions, please follow these steps:

1. Turn the unit Off.
2. Interrupt the power supply by removing the batteries.
3. Let the unit stand for a few minutes, then replace the batteries.
4. Turn the unit On. The unit should now be ready to use again.
5. If the unit still does not work, install a new set of batteries.

IMPORTANT NOTE:

If the problem persists, please call our **Consumer Services Department** at **1-800-521-2010** in the U.S., **1-877-352-8697** in Canada, or by going to our website **vtechkids.com** and filling out our **Contact Us** form located under the **Customer Support link**. Creating and developing VTech products is accompanied by a responsibility that we take very seriously. We make every effort to ensure the accuracy of the information, which forms the value of our products. However, errors sometimes can occur. It is important for you to know that we stand behind our products and encourage you to contact us with any problems and/or suggestions you might have. A service representative will be happy to help you.

NOTE

This equipment has been tested and found to comply with the limits for a Class B digital device, pursuant to Part 15 of the FCC Rules. These limits are designed to provide reasonable protection against harmful interference in a residential installation. This equipment generates, uses and can radiate radio frequency energy and, if not installed and used in accordance with the instructions, may cause harmful interference to radio communications. However, there is no guarantee that interference will not occur in a particular installation. If this equipment does cause harmful interference to radio or television reception, which can be determined by turning the equipment off and on, the user is encouraged to try to correct the interference by one or more of the following measures:

- Reorient or relocate the receiving antenna.
- Increase the separation between the equipment and receiver.
- Connect the equipment into an outlet on a circuit different from that to which the receiver is connected.
- Consult the dealer or an experienced radio/TV technician for help.

Caution: Changes or modifications not expressly approved by the party responsible for compliance could void the user's authority to operate the equipment.

Supplier's Declaration of Conformity

47 CFR § 2.1077 Compliance Information

Trade Name: VTech®
Model: 5736
Product Name: Twist Adventures™ Dino Discoveries
Responsible Party: VTech Electronics North America, L.L.C.
Address: 1156 W. Shure Drive, Suite 200,
Arlington Heights, IL 60004
Website: vtechkids.com

THIS DEVICE COMPLIES WITH PART 15 OF THE FCC RULES. OPERATION IS SUBJECT TO THE FOLLOWING TWO CONDITIONS: (1) THIS DEVICE MAY NOT CAUSE HARMFUL INTERFERENCE, AND (2) THIS DEVICE MUST ACCEPT ANY INTERFERENCE RECEIVED, INCLUDING INTERFERENCE THAT MAY CAUSE UNDESIRE OPERATION.

The information in this product is current as of the publication date. Any developments thereafter may not be reflected.

Publication Date: December 2023

**Visit our website for more
information about our products,
downloads, resources and more.**

vtechkids.com
vtechkids.ca

Read our complete warranty policy online at
vtechkids.com/warranty
vtechkids.ca/warranty



© 2023 VTech Holdings Limited.
All rights reserved.
IM-573600-004
Version:0