

**vtech**<sup>®</sup>

User's Manual

# Smarty's Workshop<sup>™</sup>



© 2002 VTECH  
Printed in China  
91-01544-005 (美)

Dear Parent,

At **VTech**<sup>®</sup> we know that children have many different learning styles. While some children respond to more structured instruction, others learn best through imaginative role-play. That's why we created **Learning Adventures**<sup>™</sup> - a line of entertaining learning products where fun-filled play comes first, and learning comes to life in thematic, 3D environments.

**Learning Adventures**<sup>™</sup> is a revolutionary way for children to learn, immersing them in an imaginative hands-on adventure. Children can direct the play and control the learning, creating a motivating environment. In all products, fundamental curriculum is seamlessly integrated into the play. Children will be having so much fun, they won't even notice that these toys are teaching too! As they expand their imaginations, children will develop age-appropriate skills ranging from language development and problem solving to communication and social skills — all while building strong self-confidence.

Products in the **Learning Adventures**<sup>™</sup> line also have charming characters that act as coaches, helping your child explore the exciting world of learning. These characters encourage children to take on new learning challenges, guide them through activities and provide positive reinforcement for a job well done.

**Learning Adventures**<sup>™</sup> products also incorporate advanced technologies that bring these characters to life, while encouraging a hands-on, multi-sensory approach to learning.

At **VTech**<sup>®</sup> we are committed to creating fun learning toys that foster a child's intellectual and social development. We thank you for trusting **VTech**<sup>®</sup> with the important job of helping your child do great things!

Sincerely,

Your Friends at **VTech**<sup>®</sup>

To learn more about **Learning Adventures**<sup>™</sup> and other **VTech**<sup>®</sup> toys, visit [www.vtechuk.com](http://www.vtechuk.com)

# INTRODUCTION

Thank you for purchasing the **VTech® Smarty's Workshop™** learning toy. We at **VTech®** are committed to providing the best possible products to entertain and educate your child. Should you have any questions or concerns, please call our Consumer Services Department at 1-800-521-2010 in the U.S., or 1-800-267-7377 in Canada.

The **VTech® Smarty's Workshop™** learning toy is an interactive workshop that is specifically designed for children ages three years and up. The **VTech® Smarty's Workshop™** features five interactive workstations and an animatronic Smarty character that will encourage your child as they explore and learn. Children can choose to build one of 50 projects, while Smarty coaches them with step-by-step instructions. Children can also choose to have fun on their own and learn about colors, numbers and shapes. Your child will be a busy builder as they interact with The **VTech® Smarty's Workshop™**.

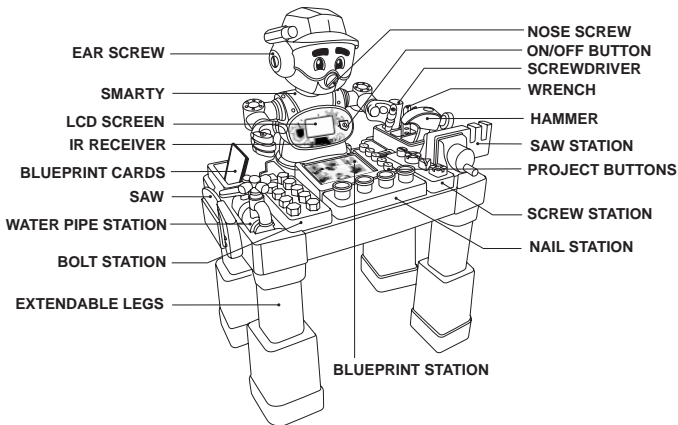

# INCLUDED IN THIS PACKAGE

- One VTech® Smarty's Workshop™ learning toy.
- Four workshop tools: screwdriver, wrench, hammer and saw.
- Five blueprint cards.
- One instruction manual.

**WARNING: All packing materials such as tape, plastic sheets, wire ties and tags are not part of this toy, and should be discarded for your child's safety.**

## BATTERY INSTALLATION

1. Make sure the unit is **OFF**.
2. Locate the battery cover on the back of the unit. Use a coin or screwdriver to open the battery cover.
3. Install 4 new "D" batteries following the diagram inside the battery box. (The use of new, alkaline batteries is recommended for maximum performance.)

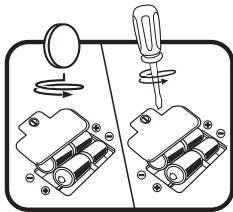

4. Replace the battery cover and tighten the screw to secure the battery cover.

## BATTERY NOTICE

- Non-rechargeable batteries are not to be recharged.
- Rechargeable batteries are to be removed from the toy before being charged (if removable).
- Rechargeable batteries are only to be charged under adult supervision (if removable).
- Different types of batteries or new and used batteries are not to be mixed.
- Only batteries of the same or equivalent type as recommended are to be used.
- Batteries are to be inserted with the correct polarity.
- Exhausted batteries are to be removed from the toy.
- The supply terminals are not to be short-circuited.
- The toy is not to be connected to more than recommended number of power supplies.
- Do not dispose of battery in fire.

**NOTE:** If the unit suddenly stops working or the sound becomes weak, turn the unit off for 15 seconds, then turn it back on. If the problem persists it may be caused by weak batteries. Please install a new set of batteries and try the unit again.

# Assembly

For proper use of the **VTech® Smarty's Workshop™**, make sure the unit is assembled properly by an adult before use. Please follow the directions below.

1. Before attaching Smarty to the workbench, push the connecting wires into the cavity on the workbench.
2. To position Smarty correctly, match the posts under Smarty with the corresponding holes on top of the workbench.

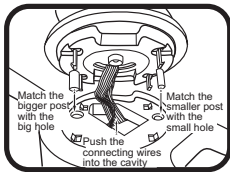

3. When Smarty is positioned properly on the workbench, apply pressure until he snaps tightly into place. This will permanently attach Smarty to the workbench. Please do not attempt to remove Smarty from the workbench, as this may cause damage to the unit.

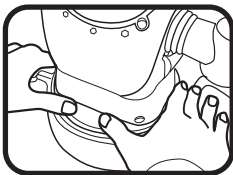
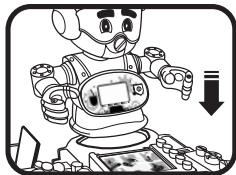

4. Plug the pencil onto the cap of Smarty.

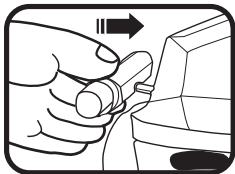

5. Insert the four legs into the bottom cabinet of the workbench. Plug leg "A" into the hole labeled "A" on the bottom of the workbench. Plug leg "B" into the hole labeled "B" on the bottom of the workbench.

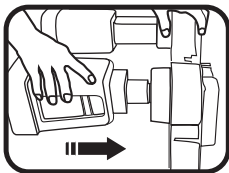

6. To adjust the height of the legs, pull out the legs and turn it 90 degrees to lock it into a secure position.

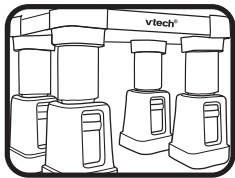
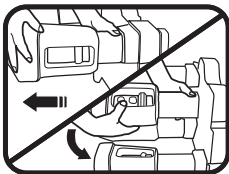

Highest position

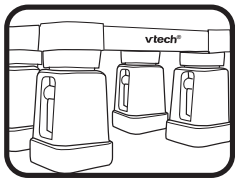

Lowest position

7. Place the tools and blueprints into their storage area.

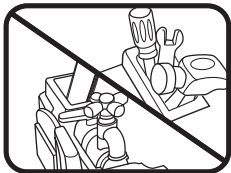

## TO BEGIN PLAY

1. To begin play, press the **ON/OFF BUTTON** to turn on the unit. You will hear an introductory melody and a friendly greeting. Smarty will respond with moving around to the workstations.

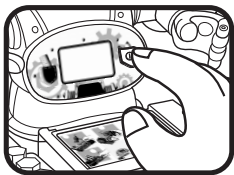

2. If there is no input for approximately 20 seconds, you will hear "Are you still there?" Smarty will respond with moving around to the workstations.

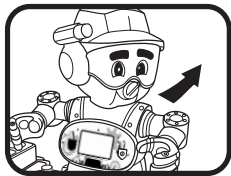

3. To turn off the unit, press the **ON/OFF BUTTON** again. You will hear the "Pack it up!" song. Smarty will dance and the **LCD SCREEN** will show the animations. The unit will turn off after the song and phrases are finished.

### AUTOMATIC SHUT-OFF

To preserve battery life, the **VTech® Smarty's Workshop™** learning toy will automatically turn off after a few minutes without input, it can be turned on again by pressing the **ON/OFF BUTTON**.



# ACTIVITIES

## Exploring Activity

1. After the unit is turned on, it automatically enters the **Exploring Activity**.
2. Use the **HAMMER** to pound the 4 light-up nails in the **NAIL STATION**. You will hear a sound effect and the light-up nail will flash with the sound. You will see a nail on the **LCD SCREEN** going down per each activation of the nail. When a nail is pounded to its lowest position, Smarty will identify its color.

Please Note: Do not put your ears near the nails when the nails are being hit strongly, this could be harmful to your hearing.

3. Use the **WRENCH** to turn the bolts on the **BOLT STATION**. As you turn the bolts, you will see the bolt turning on the **LCD SCREEN**. When a bolt is turned to its lowest position, Smarty will identify its number.
4. Use the **SCREWDRIVER** to turn the screws on the **SCREW STATION**. As you turn the screw, you will hear a screw sound effect and see the screw on the **LCD SCREEN** turning. If you turn the screw to the right, the screw on the **LCD SCREEN** will go downward. If you turn the screw to the left, the screw on the **LCD SCREEN** will go upward. When a screw is turned to its highest or lowest position, Smarty will identify its shape and size.

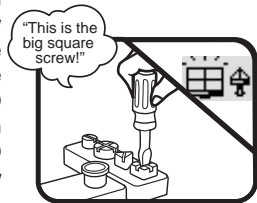
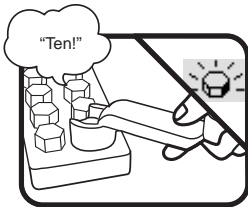

5. Use the **SAW** to saw the wood on the **SAW STATION**. As you saw the wood, you will hear a saw sound effect and hear Smarty count along with each sawing action. You will see the saw cutting the wood on the **LCD SCREEN**. If you continue to saw the wood, the wood will break into two pieces.

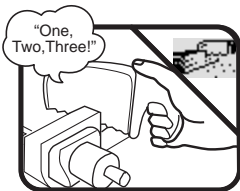

6. Turn the **FAUCET** on the **WATER PIPE STATION**. As you turn the **FAUCET** to the left or right, you will hear water sound effects at different speeds. The **LCD SCREEN** will show the water according to what speed is activated.

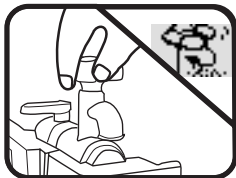

7. Turn the **LEVER** on the **WATER PIPE STATION**. As you turn the **LEVER**, you will hear either a big or small bubble sound effect. The **LCD SCREEN** will display the bubbles according to the size that is activated.

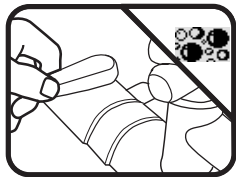

8. Turn the **NOSE SCREW** or **EAR SCREW** to hear a giggle sound effect.

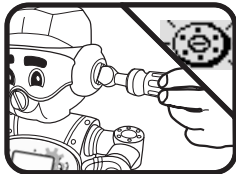

9. While in the exploring mode, Smarty will follow along to each workstation that is activated and respond with encouraging phrases, safety phrases or music. After activation of the stations for a specific time, Smarty will encourage the child to select a building project.

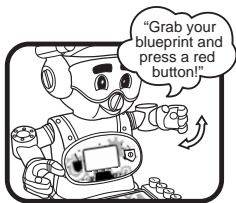

10. Press the numbers 1, 2, 3, or 4 **PROJECT BUTTON** when there is no blueprint in the **BLUEPRINT STATION** to learn how to use the tools. Smarty will instruct the child how to use the tools. After you try the corresponding tool, music will start to play. While music playing, if you activate different stations on the workbench, you will hear the instruments change according to the corresponding sound effect on the workstation.

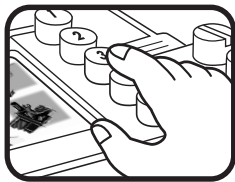

11. Press the number 5 **PROJECT BUTTON** when there is no blueprint on the **BLUEPRINT STATION** to activate the "Pack it up!" song. Smarty will dance and the **LCD SCREEN** will show the animations.

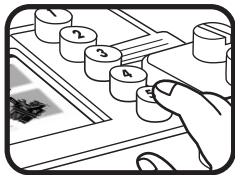

## Building Activity

1. Insert a **BLUEPRINT** into the **BLUEPRINT STATION** to begin a building project. You will be encouraged to select a project to build.



2. Press one of the 5 **PROJECT BUTTONS** to begin a building project. The projects are numbered according to their difficulty. 1 is the easiest level, 5 is the hardest level. You will see the unfinished or broken project on the **LCD SCREEN**. Smarty will begin to instruct you with step-by-step instructions to build the project.

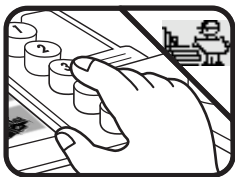

3. If you finish the steps correctly, Smarty will respond with encouraging phrases and a short melody.

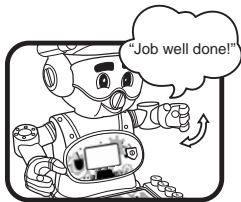

4. You will have 2 chances to follow the steps correctly. If you do not follow the steps correctly or completely on the second attempt, Smarty will come in and help finish the step.

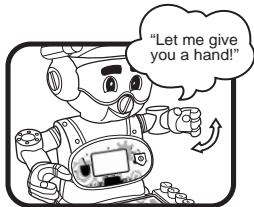

5. Smarty may respond with a random safety phrase if the hammer or saw is activated.

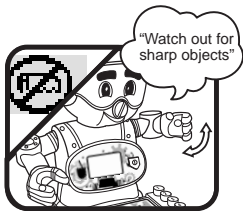

6. When 3 projects are finished, Smarty will respond with a short melody and dance.

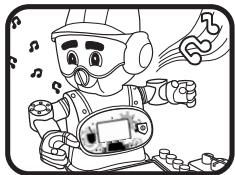

7. When all 5 projects are finished on the blueprint, Smarty will reward you with a melody and dance. While music playing, if you activate different stations on the workbench, you will hear the instruments change according to the corresponding sound effect on the workstation.

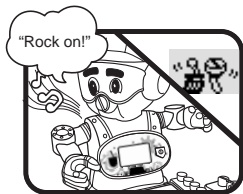

## Works with Smarty's Toolbox™

For more magical fun, you can purchase The **VTech® Smarty's Toolbox™**. When the drill or tape measure from The **VTech® Smarty's Toolbox™** is brought into The **VTech® Smarty's Workshop™**, Smarty will respond with added curriculum and fun!

1. Turn on **VTech® Smarty's Workshop™**. After the introduction melody and phrase, turn the **ELECTRIC DRILL** or **TAPE MEASURE** on. Smarty has a magical sensor that allows him to detect these tools when brought into The **VTech® Smarty Workshop™**. When Smarty detects these tools, extra melodies, curriculum and games will be activated. Please refer to The **VTech® Smarty's Toolbox™** for further details.

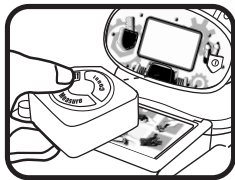
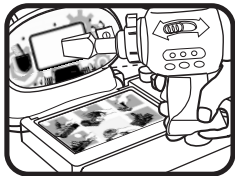

## CARE AND MAINTENANCE

1. Keep the unit clean by wiping it with a slightly damp cloth.
2. Keep the unit out of direct sunlight and away from any direct heat source.
3. Remove the batteries when the unit is not in use for an extended period of time.
4. Do not drop the unit on hard surfaces and do not expose the unit to moisture or water.

### IMPORTANT NOTE:

Creating and developing preschool products is accompanied by a responsibility that we at **VTech®** take very seriously. We make every effort to ensure the accuracy of the information which forms the value of our products. However, errors sometimes can occur. It is important for you to know that we stand behind our products and encourage you to call our Consumer Services Department at 1-800-521-2010 in the U.S., or 1-800-267-7377 in Canada, with any problems and/or suggestions that you might have. A service representative will be happy to help you.