



Parent's Guide

Peppa Pig Learning Watch



INTRODUCTION

Thank you for purchasing the Peppa Pig Learning Watch.

Play number games and more with the Peppa Pig Learning Watch! Peppa Pig makes learning fun with games that feature counting, comparing, sorting and matching. Keep the learning right at hand!



INCLUDED IN THIS PACKAGE

- Peppa Pig Learning Watch
- One CR2450 battery (placed inside the product)
- Parent's guide

WARNING

All packing materials, such as tape, plastic sheets, packaging locks, removable tags, cable ties and packaging screws are not part of this toy, and should be discarded for your child's safety.

NOTE

Please keep this parent's guide as it contains important information.

ATTENTION

Pour la sécurité de votre enfant, débarrassez-vous de tous les produits d'emballage tels que rubans adhésifs, feuilles de plastique, attaches, étiquettes et vis d'emballage. Ils ne font pas partie du jouet.

NOTE

Il est conseillé de conserver ce guide des parents car il comporte des informations importantes.

PRODUCT SPECIFICATION

BATTERY	One CR2450 battery
TIME FORMAT	12h or 24h
DISPLAY	DIGITAL
OPTIMUM OPERATING AND CHARGING TEMPERATURE	32°F - 104°F (0°C - 40°C)

Important Note:

- Do not place the watch under running water.
- Do not submerge. Not suitable for showering, bathing or swimming.
- Keep the cover closed when the watch is not in use.

Note :

- Ne pas mettre la montre sous l'eau.
- Ne pas immerger la montre et ne pas l'utiliser sous la douche et dans le bain.
- Garder le clapet fermé lorsque la montre n'est pas utilisée.

WARNING:

People with very sensitive skin may notice some irritation after wearing the Peppa Pig Learning Watch for extended periods of time. The skin may become irritated when moisture, sweat, soap or other irritants get trapped under the wristband and are left in contact with the skin. To prevent this, we suggest children remove the watch before going to bed for the night, take the watch off if it's feeling uncomfortable, and keep their wrist and the band clean and dry.

In addition, wearing the watch too tightly may also cause irritation. Make sure the fit is tight enough so the watch stays in place but not so tight that it's uncomfortable. If you notice any redness, swelling, or other irritation, you may want to consult a doctor before wearing the watch again.

PRÉCAUTIONS D'UTILISATION

Comme avec d'autres objets portés près du corps de manière prolongée, la montre interactive pourrait éventuellement provoquer une irritation. L'humidité, la transpiration, l'eau savonnée ou d'autres agents irritants peuvent s'incruster sous le bracelet et rester en contact avec la peau.

En prévention, nous recommandons fortement aux enfants de ne pas porter la montre pendant la nuit, de l'enlever dès le moindre signe d'irritation, et de garder le bracelet sec et propre. Par ailleurs, vérifiez que le bracelet de votre enfant ne soit ni trop serré, ni trop lâche. Si vous observez des rougeurs, gonflements ou autre irritation, veuillez consulter un médecin avant de remettre la montre.

GETTING STARTED

POWER SOURCE

The Peppa Pig Learning Watch operates using a CR2450 battery. The CR2450 battery included with the product is for demo purposes only.

BATTERY REMOVAL AND INSTALLATION

NOTE: For best performance, remove the factory-installed battery from the Peppa Pig Learning Watch and use a new battery.

1. Make sure the unit is turned **Off**.
2. Find the battery cover located on the back of the unit, use a screwdriver to loosen the screw and then open the battery cover.
3. Remove the old battery by pulling up on one end of the battery.
4. Install one new CR2450 battery following the diagram inside the battery cover.
5. Replace the battery cover and tighten the screw to secure.

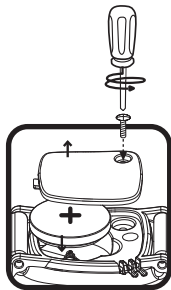

IMPORTANT: BATTERY INFORMATION

- Insert batteries with the correct polarity (+ and -).
- Do not mix old and new batteries.
- Do not mix alkaline, standard (carbon-zinc), or rechargeable batteries.
- Only batteries of the same or equivalent type as recommended are to be used.
- Do not short-circuit the supply terminals.
- Remove batteries during long periods of non-use.
- Remove exhausted batteries from the toy.
- Dispose of batteries safely. Do not dispose of batteries in fire.

RECHARGEABLE BATTERIES:

- Remove rechargeable batteries from the toy before charging
- Rechargeable batteries are only to be charged under adult supervision.
- Do not charge non-rechargeable batteries.



WARNING:

Adult assembly required for battery installation.
Keep batteries out of reach of children.



ATTENTION :

Les piles ou accumulateurs doivent être installés par un adulte.
Tenir les piles ou accumulateurs hors de portée des enfants.



WARNING

This product contains one or more button cell or coin batteries. If swallowed, a button cell or coin battery can cause internal chemical burns in as little as two hours and can lead to death. Dispose of used batteries immediately. Keep new and used batteries away from children. If you think batteries might have been swallowed or placed inside any part of the body, seek immediate medical attention and go straight to the nearest hospital emergency department.



ATTENTION

Ce produit contient une ou plusieurs piles boutons. En cas d'ingestion, une pile bouton peut provoquer, en moins de deux heures, de graves brûlures chimiques internes pouvant conduire à la mort. Trier immédiatement les piles usagées. Tenir les piles neuves et usagées hors de portée des enfants.

Si vous pensez que des piles ont pu être avalées ou placées à l'intérieur d'une partie du corps de votre enfant, il faut consulter immédiatement un médecin aux urgences hospitalières.

Australia / New Zealand:

If you suspect your child has swallowed or placed a button cell / coin battery inside any part of their body, immediately call the 24-hour Poisons Information Centre on 13 11 26 (in Australia) or 24-hour National Poisons Centre on 0800 764 766 (in New Zealand) for fast, expert advice and go straight to the nearest hospital emergency room.

TO BEGIN USING THE PEPPA PIG LEARNING WATCH

When you use the watch for the first time, open the cover, then press the **Left + Right + OK Buttons** for approximately 5 seconds to unlock the Try-Me mode. You will hear three beeping sounds when the Try-Me mode is unlocked. You can then press any button to activate the watch and set the time.

Press the **Left or Right Buttons** to select, then press the **OK Button** to confirm and move to the next option. A checkmark will be displayed when the setting is complete.

Note:

- When the battery level is low, most functions on the watch may not be activated, except for the clock display. It is recommended to replace with a new battery as soon as possible before further use.
- If the battery level is too low and cannot keep the clock running, you will need to enter the time and date again after the battery has been replaced.

ACTIVITIES & FEATURES

Cover

Open the cover to view the time. When the cover is closed, tap the bottom of the cover to activate Peppa Pig phrases with a fun light effect.

Left/Right Buttons

Use the **Left or Right Buttons** to select an activity or option, or to select option five in settings or navigate through the games.

Light-Up OK Button

Press the **Light-Up OK Button** to confirm a selection and move to the next option in an activity.

Clock/Home Button

Press the **Clock/Home Button** to return to the clock from any other function or activity.

Clock Display

When the **Clock/Home Button** is pressed, the time will be displayed. Press the **Left** or **Right Buttons** to display the **Home Menu** where other activities and settings can be selected.

Home Menu

Press the **Left** or **Right Buttons** to display the **Home Menu**. There are five options to choose from:

1. Alarm Clock 	2. Stopwatch 	3. Timer 
4. Games 	5. Settings 	

- Press the **Left** or **Right Buttons** to scroll through the menu options.
- Press the **OK Button** to confirm.

Alarm Clock

You can set an alarm with a choice of three alarm tones.

- Press the **Left** or **Right Buttons** to select the time/ alarm tone.
- Press the **OK Button** to confirm and move to the next setting.
- Press the **Clock Button** to automatically save the current setting.



Stopwatch

Access the stopwatch here.

- Press the **OK Button** to start the stopwatch; press again to stop.
- When the stopwatch is stopped, you can press the **Left** or **Right Buttons** to reset.



Timer

Set a countdown timer here.

- Press the **Left** or **Right Buttons** to change the time.
- Press the **OK Button** to confirm.
- When you press the **OK Button** to confirm the timer duration, the countdown will start immediately.
- While the timer is running, you can press the **OK Button** to pause/resume. When it is paused, you can press the **Left** or **Right Buttons** to reset.



Games

In the Games menu, press the **Left** or **Right Buttons** to scroll through the different progressive learning game options:

1. Count With Peppa

Count the number of fish in the tank. Press the **Left** or **Right Buttons** to select the answer, and press the **OK Button** to confirm.

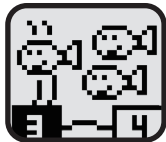

2. Ball & Hoops

Choose the smallest or largest number to shoot the ball into the hoop. Once the ball is under the number hoop you desire, press the **OK Button** to shoot the ball.



3. Fruits or Vegetables

Pick out fruits or vegetables from the conveyor belt. Press the **OK Button** to choose the answer.



4. Matching Shadows

Match the shadow with the correct image of an animal or friend. Press the **Left** or **Right Buttons** to select the answer; then press the **OK Button** to confirm.



Settings

In the Settings menu, press the **Left** or **Right Buttons** to scroll through the various options:

1. Clock Face

- Press the **Left** or **Right Buttons** to select from eight different clock faces.
- Press the **OK Button** to confirm.



2. Cuckoo Clock

- When the Cuckoo Clock is activated, the watch will briefly chime and show the clock at the top of each hour between 7 AM and 7 PM. The Cuckoo Clock will not ring if a game is in progress or the Alarm or Timer is ringing.
- Press the **Left** or **Right Buttons** to turn the Cuckoo Clock **On** or **Off**.
- Press the **OK Button** to confirm.



3. Time Setting

- Press the **Left** or **Right Buttons** to change the options. (Note: The AM/PM setting is only applicable in 12-hour time format.)
- Press the **OK Button** to confirm.



AUTOMATIC SHUT-OFF

To preserve battery life, the Peppa Pig Learning Watch will automatically shut off after approximately 30 seconds without input. The unit can be turned on again by pressing any button or opening the cover.

The unit will also automatically turn **Off** when the battery power is very low. If you see the Low Battery icon appear on screen, please replace the battery.

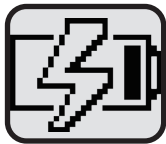

Note: The Peppa Pig Learning Watch will not automatically power off when the Stopwatch is running.

CARE & MAINTENANCE

1. Keep the unit clean by wiping it with a slightly damp cloth. Never use solvents or abrasives.
2. Keep the unit out of direct sunlight and away from any direct heat sources.
3. Remove the battery if the unit will not be in use for an extended period of time.
4. Do not drop the unit on hard surfaces and do not attempt to dismantle it.
5. Do not expose the unit to moisture or water.

TROUBLESHOOTING

CAUTION

Changes or modifications not expressly approved by the party responsible for compliance could void the user's authority to operate the equipment.

If for some reason the unit stops working or malfunctions, please follow these steps:

1. Turn the unit Off.
2. Interrupt the power supply by removing the battery.
3. Let the unit stand for a few minutes, then replace the battery.
4. Turn the unit back On. The unit should now be ready to use again.
5. If the unit still does not work, install with a new battery.

IMPORTANT NOTE:

If the problem persists, please call our **Consumer Services Department** at 1-800-521-2010 in the U.S., 1-877-352-8697 in Canada, or by going to our website vtechkids.com and filling out our **Contact Us** form located under the **Customer Support** link. Creating and developing VTech products is accompanied by a responsibility that we take very seriously. We make every effort to ensure the accuracy of the information, which forms the value of our products. However, errors sometimes can occur. It is important for you to know that we stand behind our products and encourage you to contact us with any problems and/or suggestions you might have. A service representative will be happy to help you.

NOTE

This equipment has been tested and found to comply with the limits for a Class B digital device, pursuant to Part 15 of the FCC Rules. These limits are designed to provide reasonable protection against harmful interference in a residential installation. This equipment generates, uses and can radiate radio frequency energy and, if not installed and used in accordance with the instructions, may cause harmful interference to radio communications. However, there is no guarantee that interference will not occur in a particular installation. If this equipment does cause harmful interference to radio or television reception, which can be determined by turning the equipment off and on, the user is encouraged to try to correct the interference by one or more of the following measures:

- Reorient or relocate the receiving antenna.
- Increase the separation between the equipment and receiver.

- Connect the equipment into an outlet on a circuit different from that to which the receiver is connected.
- Consult the dealer or an experienced radio/TV technician for help.

Supplier's Declaration of Conformity
47 CFR § 2.1077 Compliance Information

Trade Name: VTech®
Model: 5260
Product Name: Peppa Pig Learning Watch
Responsible Party: VTech Electronics North America, LLC
Address: 1156 W. Shure Drive, Suite 200
Arlington Heights, IL 60004
Website: vtechkids.com

THIS DEVICE COMPLIES WITH PART 15 OF THE FCC RULES. OPERATION IS SUBJECT TO THE FOLLOWING TWO CONDITIONS: (1) THIS DEVICE MAY NOT CAUSE HARMFUL INTERFERENCE, AND (2) THIS DEVICE MUST ACCEPT ANY INTERFERENCE RECEIVED, INCLUDING INTERFERENCE THAT MAY CAUSE UNDESIRE OPERATION.

CAN ICES-3 (B)/NMB-3(B)

**Visit our website for more
information about our products,
downloads, resources and more.**

vtechkids.com

**Read our complete warranty policy online at
*vtechkids.com/warranty***



PEPPA PIG and all related trademarks and characters TM
& © 2020 Astley Baker Davies Ltd/Ent. One UK Ltd. and/or
Hasbro. All Rights Reserved. Used with Permission.

TM & © 2020 VTech Holdings Limited.
All rights reserved.
Printed in China.
91-003758-007 (S)