

vtech[®]
Baby

Parent's Guide

Roar & Explore Lion Teether™



INTRODUCTION

Thank you for purchasing the **VTech® Roar & Explore Lion Teether™**. This friendly lion features a soft, textured leaf to help soothe sore, teething gums. Press the light-up button or twist his mane to hear endearing phrases, sing-along songs and happy melodies that introduce early vocabulary and encourage first words.

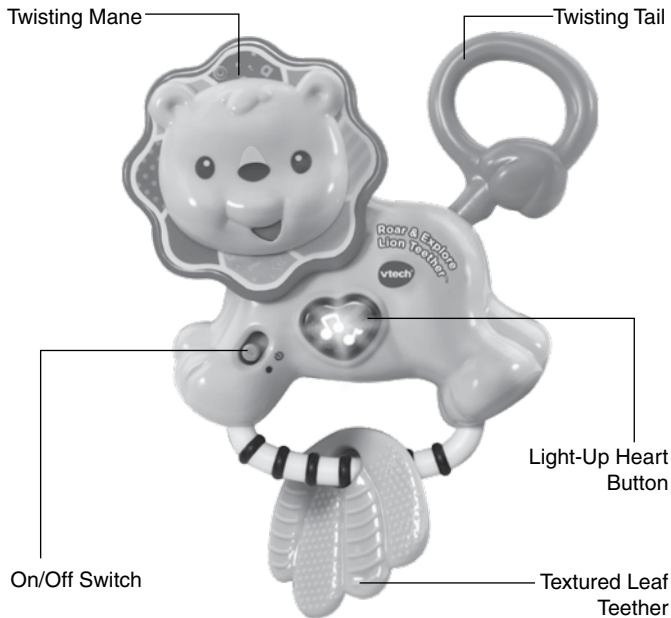

INCLUDED IN THIS PACKAGE

- One Roar & Explore Lion Teether™
- One parent's guide

WARNING: All packing materials, such as tape, plastic sheets, packaging locks, removable tags, cable ties and packaging screws are not part of this toy, and should be discarded for your child's safety.

NOTE: Please keep this parent's guide as it contains important information.

ATTENTION : Pour la sécurité de votre enfant, débarrassez-vous de tous les produits d'emballage tels que rubans adhésifs, feuilles de plastique, attaches, étiquettes et vis d'emballage. Ils ne font pas partie du jouet.

NOTE : Il est conseillé de conserver ce guide des parents car il comporte des informations importantes.

Unlock the packaging locks:

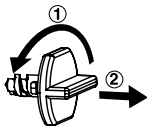

- ① Turn the packaging lock counterclockwise several times.
- ② Pull out and discard the packaging lock.

GETTING STARTED

BATTERY INSTALLATION

1. Make sure the unit is turned **OFF**.
2. Locate the battery cover on the back of the unit. Use a screwdriver to loosen the screw.
3. Install 1 new AAA (LR03/AM-4) battery following the diagram inside the battery box. (The use of a new alkaline battery is recommended for maximum performance.)
4. Replace the battery cover and tighten the screw to secure.

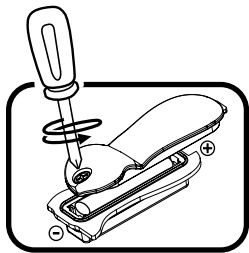

BATTERY NOTICE

- Use new alkaline batteries for maximum performance.
- Use only batteries of the same or equivalent type as recommended.
- Do not mix different types of batteries: alkaline, standard (carbon-zinc) or rechargeable (Ni-Cd, Ni-MH), or new and used batteries.
- Do not use damaged batteries.
- Insert batteries with the correct polarity.
- Do not short-circuit the battery terminals.
- Remove exhausted batteries from the toy.
- Remove batteries during long periods of non-use.
- Do not dispose of batteries in fire.
- Do not charge non-rechargeable batteries.
- Remove rechargeable batteries from the toy before charging (if removable).
- Rechargeable batteries are only to be charged under adult supervision.

PRODUCT FEATURES

1. On/Off Switch

To turn the lion **ON**, slide the **On/Off Switch** to the **ON** (⏻) position. You will hear a song and a welcoming phrase. To turn the lion **OFF**, slide the **On/Off Switch** to the **OFF** (●) position.

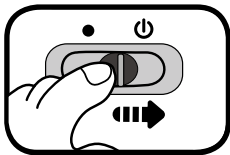

2. Automatic Shut Off

To preserve battery life, the **Roar & Explore Lion Teether™** will automatically power down after approximately 35 seconds without input. The lion can be turned on again by pressing the **Light-Up Heart Button** or turning the **Lion's Mane**. Shaking the lion will not turn the unit back on.

Note: If the unit powers down while playing, we suggest changing the batteries.

ACTIVITIES

1. Light-Up Heart Button

Press the **Light-Up Heart Button** to hear playful songs, phrases and melodies. When a melody is playing, shake the lion to hear a fun sound play over the melody. The light will flash with the sounds.

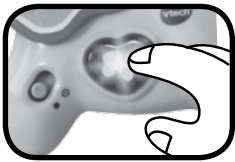

2. Twisting Mane

Twist the lion's **Mane** to trigger fun sounds. The light will flash with the sounds.



3. Twisting Tail

Twist the lion's **Tail** to hear clicking sounds and to promote motor skill development.



4. Motion Sensor

Shake the lion to activate the **Motion Sensor**, you will hear a variety of playful sounds. The light will flash with the sounds.

SONG LYRICS

SONG 1

Shake, shake, shake,
Hear what sounds I make.
Twist, twist, twist,
I shake my head and say hello.

SONG 2

I'm a lion, a cute and friendly lion,
My mane makes me feel so big and strong.

SONG 3

Hello my friend, you know I love you.
When we're together I roar and I purr!

MELODY LIST

1. Aiken Drum
2. The Daring Young Man on the Flying Trapeze
3. Frog Went A-Courting
4. Farmer in the Dell
5. One Man Went to Mow a Meadow
6. Yankee Doodle
7. The Alphabet Song
8. The Glow-Worm
9. Ta-ra-ra Boom-de-ay
10. The Muffin Man
11. Pat-A-Cake
12. Waltzing Matilda
13. Dill Pickles - Charles L. Johnson
14. Jack Be Nimble
15. Blow the Man Down

CARE & MAINTENANCE

1. Keep the unit clean by wiping it with a slightly damp cloth.
2. Keep the unit out of direct sunlight and away from any direct heat sources.
3. Remove the batteries when the unit is not in use for an extended period of time.
4. Do not drop the unit on a hard surface and do not expose the unit to excess moisture.

TROUBLESHOOTING

If for some reason the program/activity stops working, please follow these steps:

1. Turn the unit **OFF**.
2. Interrupt the power supply by removing the batteries.
3. Let the unit stand for a few minutes, then replace the batteries.
4. Turn the unit back **ON**. The unit will now be ready to play again.
5. If the unit still does not work, replace with an entire set of new batteries.

If the problem persists, please call our Consumer Services Department at 1-800-521-2010 in the U.S. or 1-877-352-8697 in Canada, or by going to our website at vtechkids.com and filling out our Contact Us form located under the Customer Support link. A service representative will be happy to help you.

IMPORTANT NOTE:

Creating and developing **VTech**[®] products is accompanied by a responsibility that we at **VTech**[®] take very seriously. We make every effort to ensure the accuracy of the information, which forms the value of our products. However, errors sometimes can occur. It is important for you to know that we stand behind our products and encourage you to call our Consumer Services Department at 1-800-521-2010 in the U.S. or 1-877-352-8697 in Canada, or by going to our website at vtechkids.com and filling out our Contact Us form located under the Customer Support link with any problems and/or suggestions that you might have. A service representative will be happy to help you.

Note:

This equipment has been tested and found to comply with the limits for a Class B digital device, pursuant to Part 15 of the FCC Rules. These limits are designed to provide reasonable protection against harmful interference in a residential installation. This equipment generates, uses and can radiate radio frequency energy and, if not installed and used in accordance with the instructions, may cause harmful interference to radio communications. However, there is no guarantee that interference will not occur in a particular installation. If this equipment does cause harmful interference to radio or television reception, which can be determined by turning the equipment off and on, the user is encouraged to try to correct the interference by one or more of the following measures:

- Reorient or relocate the receiving antenna.
- Increase the separation between the equipment and receiver.
- Connect the equipment into an outlet on a circuit different from that to which the receiver is connected.
- Consult the dealer or an experienced radio/TV technician for help.

THIS DEVICE COMPLIES WITH PART 15 OF THE FCC RULES. OPERATION IS SUBJECT TO THE FOLLOWING TWO CONDITIONS:
(1) THIS DEVICE MAY NOT CAUSE HARMFUL INTERFERENCE, AND
(2) THIS DEVICE MUST ACCEPT ANY INTERFERENCE RECEIVED, INCLUDING INTERFERENCE THAT MAY CAUSE UNDESIRE OPERATION.

CAN ICES-3 (B)/NMB-3(B)

Caution: Changes or modifications not expressly approved by the party responsible for compliance could void the user's authority to operate the equipment.

**Visit our website for more
information about our products,
downloads, resources and more.**

vtechkids.com

Read our complete warranty policy online at
vtechkids.com/warranty



TM & © 2017 VTech Holdings Limited.
All rights reserved.

Printed in China.

91-003471-004 (S) (E)