

vtech[®]

User's Manual

**Lil' Critters Learn &
Go Activity Bug™**

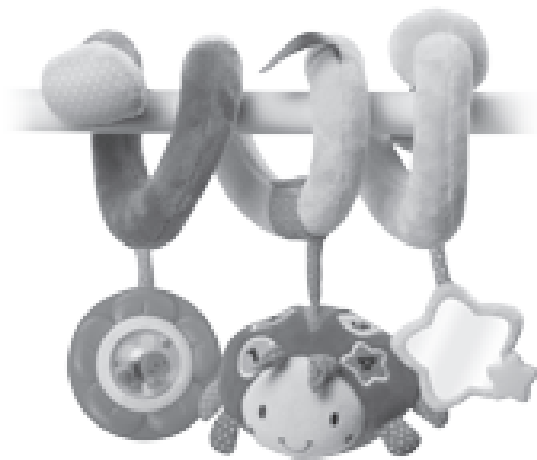

© 2014 VTech
Printed in China
91-002889-004 US CA

Dear Parent,

Ever notice the look on your baby's face when they learn something new through their own discovery? These self-accomplished moments are a parent's greatest reward. To help fulfill them, **VTech**[®] created the **Infant Learning**[®] series of toys.

These unique interactive learning toys directly respond to what children do naturally – play! Using innovative technology, these toys react to baby's interactions, making each play experience fun and unique as they learn age-appropriate concepts like first words, numbers, shapes, colors and music. More importantly, **VTech**[®]'s **Infant Learning**[®] toys develop baby's mental and physical abilities by inspiring, engaging and teaching.

At **VTech**[®], we know that a child has the ability to do great things. That's why all of our electronic learning products are uniquely designed to develop a child's mind and allow them to learn to the best of their ability. We thank you for trusting **VTech**[®] with the important job of helping your child learn and grow!

Sincerely,

Your friends at **VTech**[®]

To learn more about the **Infant Learning**[®] series and other **VTech**[®] toys, visit www.vtechkids.com

INTRODUCTION

Thank you for purchasing the **VTech® Lil' Critters Learn & Go Activity Bug™** learning toy!

Get ready to shake, cuddle and sing with the **VTech® Lil' Critters Learn & Go Activity Bug™**! With a soft cuddly detachable ladybug and hanging manipulative features, this toy can be transported anywhere with baby for on-the-go fun! Press the colored shapes on the ladybug's back to learn colors, numbers and shapes! Hear fun responses, sing-along songs and melodies for even more fun!

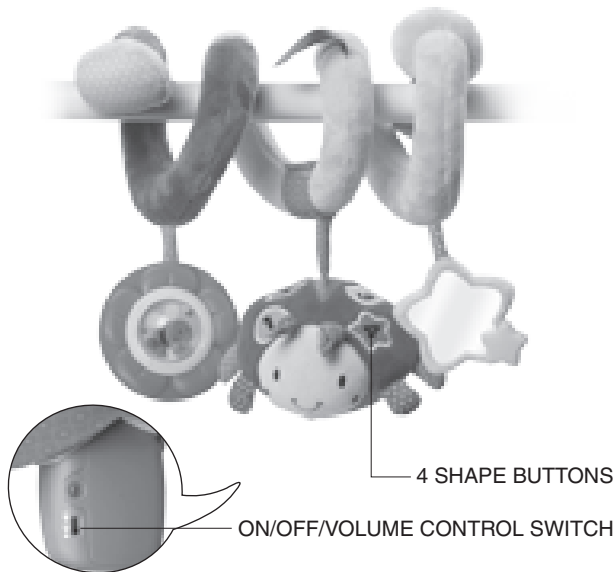

INCLUDED IN THIS PACKAGE

- One VTech® Lil' Critters Learn & Go Activity Bug™ learning toy
- One user's manual

WARNING:

All packing materials, such as tape, plastic sheets, packaging locks and tags are not part of this toy, and should be discarded for your child's safety.

ATTENTION :

Pour la sécurité de votre enfant, débarrassez-vous de tous les produits d'emballage tels que rubans adhésifs, feuilles de plastique, attaches et étiquettes. Ils ne font pas partie du jouet.

NOTE:

Please keep this instruction manual as it contains important information.

WARNING:

To protect your children from being scratched by the velcro like attachment strap, please tuck the velcro like attachment strap into the back of the ladybug when it is being played with seperately.

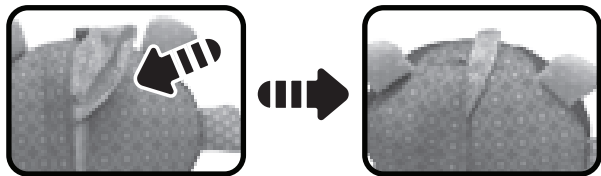

GETTING STARTED

BATTERY INSTALLATION

1. Make sure the unit is turned **OFF**.
2. Locate the battery cover on the back of the removable electronic box located inside the back of the ladybug. Use a screwdriver to loosen the screw.
3. Install 2 new AAA (AM-4/LR03) batteries following the diagram inside the battery box. (The use of new alkaline batteries is recommended for maximum performance.)
4. Replace the battery cover and tighten the screw to secure.

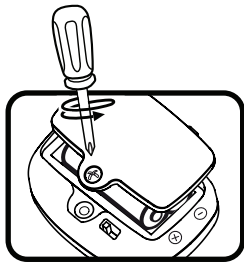

BATTERY NOTICE

- Use new alkaline batteries for maximum performance.
- Use only batteries of the same or equivalent type as recommended.
- Do not mix different types of batteries: alkaline, standard (carbon-zinc) or rechargeable (Ni-Cd, Ni-MH), or new and used batteries.
- Do not use damaged batteries.
- Insert batteries with the correct polarity.
- Do not short-circuit the battery terminals.
- Remove exhausted batteries from the toy.
- Remove batteries during long periods of non-use.
- Do not dispose of batteries in fire.
- Do not charge non-rechargeable batteries.
- Remove rechargeable batteries from the toy before charging (if removable).
- Rechargeable batteries are only to be charged under adult supervision.

PRODUCT FEATURES

1. ON/OFF/VOLUME CONTROL SWITCH

To turn the unit **ON**, slide the **ON/OFF/VOLUME CONTROL SWITCH** located on the battery box to the **LOW VOLUME** (🔊) or the **HIGH VOLUME** (🔊) position. To turn the unit **OFF**, slide the **ON/OFF/VOLUME CONTROL SWITCH** to the **OFF** (●) position.

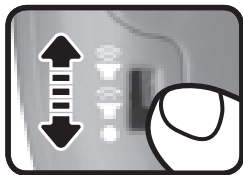

2. AUTOMATIC SHUT-OFF

To preserve battery life, the VTech® Lil' Critters Learn & Go Activity Bug™ will automatically power-down after approximately 55 seconds without input. The unit can be turned on again by pressing any button.

ACTIVITIES

1. Slide the **on/off/volume control switch** to the **ON** position. You will hear a fun sound and a happy sung song.
2. Press the **number one/green circle button** to learn the number one, the color and shape name. You will also hear fun sound effects.

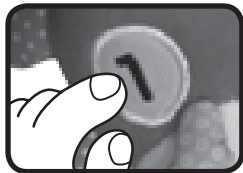
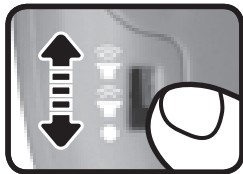

3. Press the **number two/blue triangle button** to learn the number two, the color and shape name. You will hear a fun sung song.

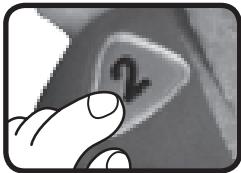

4. Press the **number three/yellow square button** to learn the number three, the color and shape name. You will hear two fun sung songs.

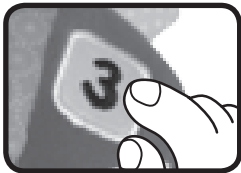

5. Press the **number four/orange star button** to learn the number four, the color and shape name. You will hear a variety of relaxing melodies.

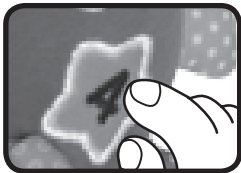

6. Shake the ladybug and a variety of fun sound effects will play.



MELODY LIST

1. Chopsticks
2. Farmer in the Dell
3. Frere Jacques
4. Happy Farmer
5. Oh Susanna
6. Polly Put the Kettle On
7. Yankee Doodle
8. Skip to My Lou
9. Twinkle, Twinkle, Little Star
10. Flight of the Bumble Bee
11. This Old Man
12. Boys and Girls Go Out to Play
13. Lavender's Blue
14. Little Boy Blue
15. Bicycle Built For Two
16. Beautiful Dreamer
17. Toyland
18. Ring Around the Rosy
19. Alouette
20. Turkey in the Straw
21. Pop! Goes the Weasel
22. Aiken Drum

SUNG SONG LYRICS

SONG 1

I'm a ladybug and I can fly,
I love to flutter from flower to flower.

SONG 2

1, 2, 3, look at me,
4, 5, 6, I can do tricks,
7, 8, 9 and 10, let's see if I can do it again!

SONG 3

I am small and I am red,
With four colourful shapes on my back,
Green, orange, blue and yellow!

CARE & MAINTENANCE

1. Surface washable only. **Do not immerse this product in water as it contains electronic parts.**
2. Keep the unit clean by wiping it with a slightly damp cloth.
3. Keep the unit out of direct sunlight and away from any direct heat source.
4. Remove the batteries when the unit will not be in use for an extended period of time.
5. Do not drop the unit on hard surfaces and do not expose the unit to moisture or water.

TROUBLESHOOTING

If for some reason the program/activity stops working or malfunctions, please follow these steps:

1. Please turn the unit **OFF**.
2. Interrupt the power supply by removing the batteries.
3. Let the unit sit for a few minutes, then replace the batteries.
4. Turn the unit **ON**. The unit should now be ready to play again.
5. If the product still does not work, replace with an entire set of new batteries.

If the problem persists, please call our Consumer Services Department at 1-800-521-2010 in the U.S. or 1-877-352-8697 in Canada, and a service representative will be happy to help you.

For information on this product's warranty, please call VTech® at 1-800-521-2010 in the U.S. or 1-877-352-8697 in Canada.

IMPORTANT NOTE:

Creating and developing **Infant Learning** products is accompanied by a responsibility that we at **VTech®** take very seriously. We make every effort to ensure the accuracy of the information, which forms the value of our products. However, errors sometimes can occur. It is important for you to know that we stand behind our products and encourage you to call our Consumer Services Department at 1-800-521-2010 in the U.S. or 1-877-352-8697 in Canada, with any problems and/or suggestions that you might have. A service representative will be happy to help you.

Note:

This equipment has been tested and found to comply with the limits for a Class B digital device, pursuant to Part 15 of the FCC Rules. These limits are designed to provide reasonable protection against harmful interference in a residential installation. This equipment generates, uses and can radiate radio frequency energy and, if not installed and used in accordance with the instructions, may cause harmful interference to radio communications. However, there is no guarantee that interference will not occur in a particular installation. If this equipment does cause harmful interference to radio or television reception, which can be determined by turning the equipment off and on, the user is encouraged to try to correct the interference by one or more of the following measures:

- Reorient or relocate the receiving antenna
- Increase the separation between the equipment and receiver
- Connect the equipment into an outlet on a circuit different from that to which the receiver is connected
- Consult the dealer or an experienced radio/TV technician for help

Caution: Changes or modifications not expressly approved by the party responsible for compliance could void the user's authority to operate the equipment.

THIS DEVICE COMPLIES WITH PART 15 OF THE FCC RULES. OPERATION IS SUBJECT TO THE FOLLOWING TWO CONDITIONS:
(1) THIS DEVICE MAY NOT CAUSE HARMFUL INTERFERENCE, AND
(2) THIS DEVICE MUST ACCEPT ANY INTERFERENCE RECEIVED, INCLUDING INTERFERENCE THAT MAY CAUSE UNDESIRE OPERATION.

CAN ICES-3 (B)/NMB-3(B)