

**vtech**<sup>®</sup>

User's Manual



# Alphabet Train Station<sup>™</sup>



© 2006 VTech  
Printed in China

91-02193-007-000 (美)

**Dear Parent:**

Ever notice the look on your baby's face when they learn something new through their own discovery? These self-accomplished moments are a parent's greatest reward. To help fulfill them, VTech® created the **Infant Learning**, series of toys.

These unique interactive learning toys directly respond to what children do naturally – play! Using innovative technology, these toys react to baby's interactions, making each play experience fun and unique as they learn age-appropriate concepts like first words, numbers, shapes, colors and music. More importantly, VTech®'s **Infant Learning** toys develop baby's mental and physical abilities by inspiring, engaging and teaching.

At VTech®, we know that a child has the ability to do great things. That's why all of our electronic learning products are uniquely designed to develop a child's mind and allow them to learn to the best of their ability. We thank you for trusting VTech® with the important job of helping your child learn and grow!

Sincerely,

Your Friends at VTech®

To learn more about **Infant Learning**, and other VTech® toys, visit

[www.vtechkids.com](http://www.vtechkids.com)

# INTRODUCTION

Thank you for purchasing the **VTech® SmartVille™ Alphabet Train Station™** learning toy!

The **VTech® SmartVille™ Alphabet Train Station™** is an electronic playset for toddlers 12 months and up. Go on an amazing learning journey with the animals. Insert the animals and role-play pieces into the hot spots to introduce fun phrases, sounds and more. The alphabet train track identifies letter names, letter sounds and related objects when the buttons are pressed. Turn the clock hand for an early lesson in time concepts. The light-up screen rewards toddlers with fun animations to reinforce learning.

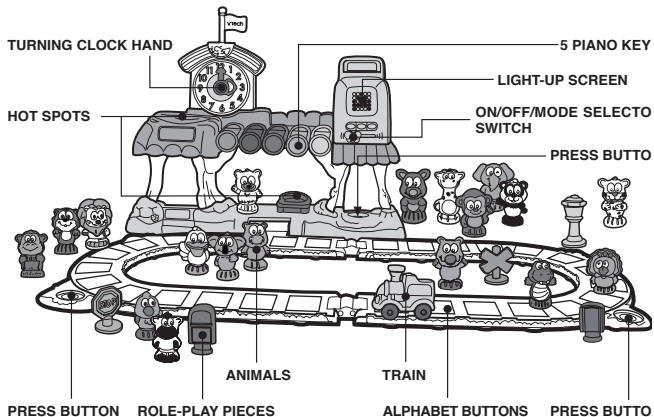

# INCLUDED IN THIS PACKAGE

- One VTech® SmartVille™ Alphabet Train Station™

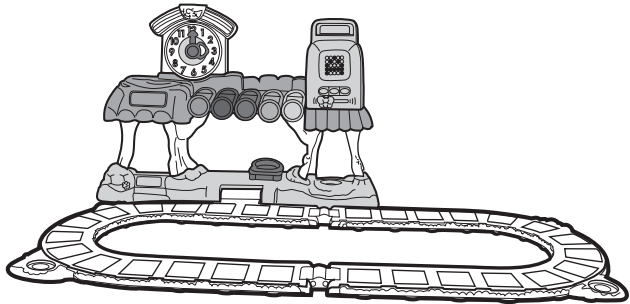

- 25 Smart Parts - including 18 animals and 7 role-play pieces

## Animals



Hippo



Polar bear



Giraffe



Gorilla



Kangaroo



Elephant



Tiger



Koala



Panda



Lion



Pelican



Monkey



Zebra



Crocodile



Rhinoceros



Parrot



Peacock



Cheetah

## Role-Play Pieces



Stop sign



Train crossing sign



Lamp post



Garbage can



Telephone booth



Flag



Train

One Smart Parts storage bag

- One instruction manual

**WARNING:** All packing materials, such as tape, plastic sheets, wire ties and tags are not part of this toy, and should be discarded for your child's safety.

## GETTING STARTED

### BATTERY INSTALLATION

1. Make sure the unit is turned **OFF**.
2. Locate the battery cover on the back of the unit. Use a coin or screwdriver to loosen the screw.
3. Install 3 new “AA” size (UM3/LR6) batteries following the diagram inside the battery box. (The use of new alkaline batteries is recommended for maximum performance.)
4. Replace the battery cover and tighten the screw to secure the battery cover.

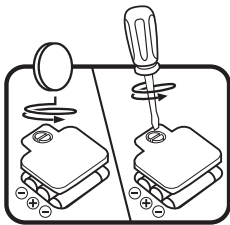

## BATTERY NOTICE

- Install batteries correctly observing the polarity (+, -) signs to avoid leakage.
- Do not mix old and new batteries.
- Do not mix batteries of different types: alkaline, standard (carbon-zinc) or rechargeable (nickel-cadmium).
- Remove batteries from the equipment when the unit will not be used for an extended for an extended period of time.
- Always remove exhausted batteries from the equipment.
- Do not dispose of battery in fire.
- Do not attempt to recharge ordinary batteries.
- The supply terminals are not to be short-circuited.
- Only batteries of the same or equivalent type as recommended are to be used.

**WE DO NOT RECOMMEND THE USE OF RECHARGEABLE BATTERIES.**



## PRODUCT FEATURES

### 1. ON/OFF/MODE SELECTOR SWITCH

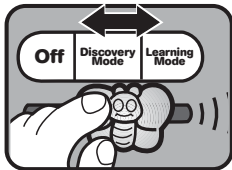
To turn the unit **ON**, slide the **ON/OFF/MODE SELECTOR SWITCH** to the **DISCOVERY MODE** or **LEARNING MODE** position. To turn the unit **OFF**, slide the **ON/OFF/MODE SELECTOR SWITCH** to the **OFF** position.



## 2. VOLUME CONTROL SWITCH

To adjust the volume, slide the **VOLUME CONTROL SWITCH** located on the bottom of the unit to the (  ) position for **LOW VOLUME** or the (  ) position for **HIGH VOLUME**.

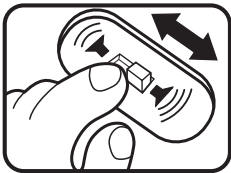

## 3. AUTOMATIC SHUT-OFF

To preserve battery life, the **VTech® SmartVille™ Alphabet Train Station™** learning toy will automatically power-down after approximately two minutes without input. The unit can be turned on again by pressing any button.

## ACTIVITIES

1. Slide the **on/off/mode selector switch** to turn the unit on. You will hear a choo choo sound effect followed by a phrase and The Alphabet Song. An animation will appear on the light-up screen.
2. Press the **piano keys** to hear music notes or learn about colors and shapes depending on the selected mode. An animation will appear on the light-up screen.

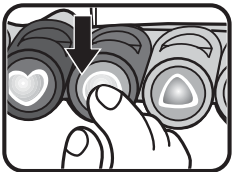
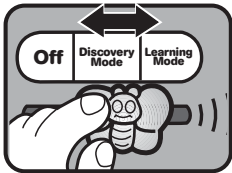

3. Turn the **clock hand** to hear numbers or time phrases depending on the selected mode. An animation will appear on the light-up screen.

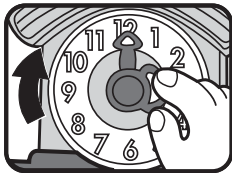

4. Insert an animal or role-play piece into the **hot spots** below the light-up screen to hear a variety of fun phrases and sounds. An animation will appear on the light-up screen.

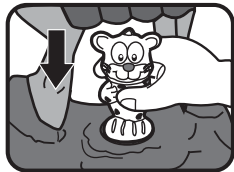

5. Insert an animal or role-play piece into the **hot spots** or press the **hot spots** with or without an animal or accessory piece to hear a variety of fun phrases, sounds and melodies. An animation will appear on the light-up screen.

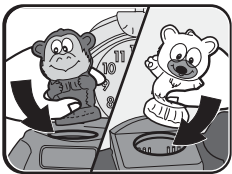

6. Press the **alphabet buttons** to learn about letters and letter sounds in the learning mode. In the discovery mode, the objects will be identified. An animation will appear on the light-up screen.

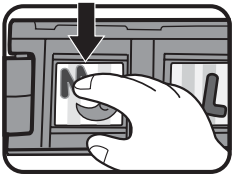



7. Press the **star button** on the train track to hear The Alphabet Song. An animation will appear on the light-up screen.

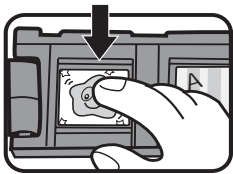

8. Press the **music button** on the train track to hear a variety of melodies. An animation will appear on the light-up screen.

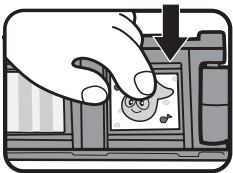

10. Place an animal or role-play piece on one of the buttons of the train track to hear a variety of melodies. An animation will appear on the light-up screen.

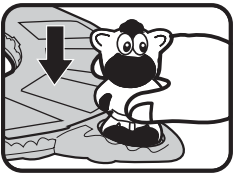

11. Roll the train along the track to hear a variety of train sound effects, phrases, melodies and The Alphabet Song. An animation will appear on the light-up screen.

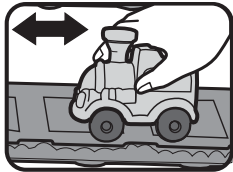

## MELODY LIST

1. If You're Happy and You Know It
2. Turkey in the Straw
3. Oh! Susanna
4. I've Been Working on the Railroad
5. She'll Be Coming Round the Mountain

## The Alphabet Song

A-B-C-D-E-F-G

H-I-J-K-L-M-N-O-P

Q-R-S-T-U-V

W-X-Y and Z

Now you know your ABC's,

Next time won't you sing with me.

## CARE & MAINTENANCE

1. Keep the unit clean by wiping it with a slightly damp cloth.
2. Keep the unit out of direct sunlight and heat source.
3. Remove the batteries when the unit is not in use for an extended period of time.
4. Do not drop the unit on hard surfaces and do not expose the unit to moisture or water.

# TROUBLESHOOTING

If for some reason the program/activity stops working, please follow these steps:

1. Turn the unit **OFF**.
2. Interrupt the power supply by removing the batteries.
3. Let the unit stand for a few minutes, then replace the batteries.
4. Turn the unit **ON**. The unit should now be ready to play again.
5. If the product still does not work, replace with a new set of batteries.

If the problem persists, please call our Consumer Services Department at 1-800-521-2010 in the U.S. or 1-877-352-8697 in Canada, and a service representative will be happy to help you.

**IMPORTANT NOTE:**

Creating and developing **Infant Learning** products is accompanied by a responsibility that we at **VTech®** take very seriously. We make every effort to ensure the accuracy of the information, which forms the value of our products. However, errors sometimes can occur. It is important for you to know that we stand behind our products and encourage you to call our Consumer Services Department at 1-800-521-2010 in the U.S. or 1-877-352-8697 in Canada, with any problems and/or suggestions that you might have. A service representative will be happy to help you.

**Note:**

This equipment has been tested and found to comply with the limits for a Class B digital device, pursuant to Part 15 of the FCC Rules. These limits are designed to provide reasonable protection against harmful interference in a residential installation. This equipment generates, uses and can radiate radio frequency energy and, if not installed and used in accordance with the instructions, may cause harmful interference to radio communications. However, there is no guarantee that interference will not occur in a particular installation. If this equipment does cause harmful interference to radio or television reception, which can be determined by turning the equipment off and on, the user is encouraged to try to correct the interference by one or more of the following measures:

- Reorient or relocate the receiving antenna
- Increase the separation between the equipment and receiver
- Connect the equipment into an outlet on a circuit different from that to which the receiver is connected
- Consult the dealer or an experienced radio/TV technician for help

THIS DEVICE COMPLIES WITH PART 15 OF THE FCC RULES. OPERATION IS SUBJECT TO THE FOLLOWING TWO CONDITIONS: (1) THIS DEVICE MAY NOT CAUSE HARMFUL INTERFERENCE, AND (2) THIS DEVICE MUST ACCEPT ANY INTERFERENCE RECEIVED, INCLUDING INTERFERENCE THAT MAY CAUSE UNDESIRE OPERATION.

THIS CLASS B DIGITAL APPARATUS COMPLIES WITH CANADIAN ICES-003.

CET APPAREIL NUMÉRIQUE DE LA CLASSE B EST CONFORME À LA NORME NMB-003 DU CANADA.

Caution: Changes or modifications not expressly approved by the party responsible for compliance could void the user's authority to operate the equipment.



# SmartVille™

## Collect them all!

Every SmartVille™ play set features talking, teaching Smart Parts!

Alphabet Train Station™



1-2-3 Treehouse™



Safe & Sound Fire Station™



Musical Band Stand™



Ice Cream Color Shop™



ABC Post Office™

