

*Dear Parent:*

*At VTech® we know that a child has the ability to do great things. That's why all of our electronic learning products are uniquely designed to develop a child's mind and allow them to learn to the best of their ability. Whether it's introducing numbers and letters, identifying colors and shapes, or stimulating senses with lights and music, all VTech® infant and toddler learning products encourage your child's natural growth and discovery skills. When it comes to providing electronic learning products that enlighten, entertain and develop minds, at VTech® we see the potential in every child.*

# INTRODUCTION

Thank you for purchasing **VTech® Safari Gym™** learning toy! This product is one of a family of high quality electronic learning toys. We at **VTech®** are committed to providing the best possible products to entertain and educate your child. Should you have any questions or concerns, please call our Consumer Services Department at 1-800-521-2010 in the U.S. or 1-800-267-7377 in Canada.

The **VTech® Safari Gym™** is specifically designed for infants from birth and up. As baby interacts with the animals surrounding the gym, they will hear friendly phrases, lights, sound effects and music. Baby will also be encouraged to practice their first kicks. They will magically be rewarded with lights and sounds with each kick baby makes. The **VTech® Safari Gym™** will provide your child with hours of entertainment and learning.

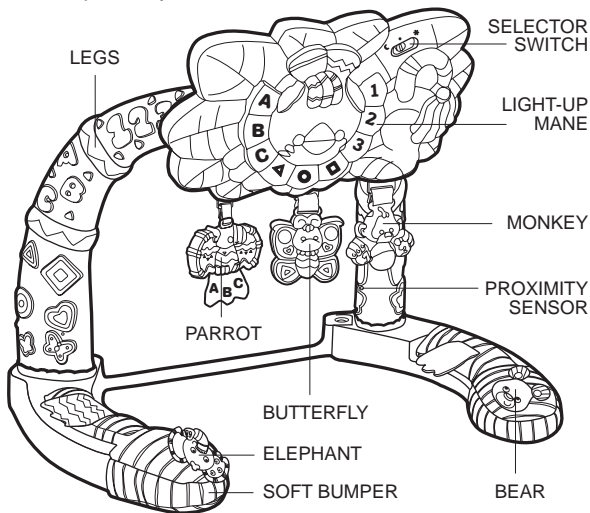

# INCLUDED IN THIS PACKAGE

1. One main board of VTech® Safari Gym™ learning toy.
2. Three **hanging characters** (parrot, monkey, butterfly)
3. Two **legs** and a screw for the unit to link up the main board to the base.
4. A **base** and screw for each side of the gym to attach with the legs for standing on the floor.
5. Two **soft bumpers** for the legs.
6. One **bridge** to line the left and right base together.
7. Two **straps** for attaching on the crib.
8. One instruction manual

**WARNING:** All packing materials, such as tape, plastic sheets, wire ties and tags are not part of this toy, and should be discarded for your child's safety.

## BATTERY INSTALLATION

1. Make sure the unit is turned off.
2. Locate the battery cover on the back of the unit. Use a screwdriver to loosen the screw.
3. Install 3 new “AA” (UM-3/LR6) batteries following the diagram inside the battery box. (The use of new alkaline batteries is recommended for maximum performance.)
4. Replace the battery cover and tighten the screw to secure the battery cover.

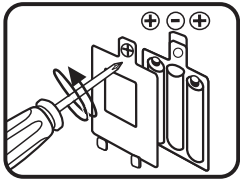

# BATTERY NOTICE

- Install batteries correctly observing the polarity ( +, - ) signs to avoid leakage.
- Do not mix old and new batteries.
- Do not use batteries of different types.
- Remove batteries from the equipment when the unit will not be used for an extended period of time.
- Do not dispose of batteries in fire.
- Do not attempt to recharge ordinary batteries.
- The supply terminals are not to be short-circuited.
- Only batteries of the same and equivalent type as recommended are to be used.

## **WE DO NOT RECOMMEND THE USE OF RECHARGEABLE BATTERIES.**

**NOTE:** If for any reason the program/activity stops working, please follow these steps:

1. Please turn the unit **OFF**.
2. Interrupt the power supply by removing the batteries.
3. Let the unit stand for a few minutes, then replace the batteries.
4. Turn the unit **ON**. The unit should now be ready to play again.

If the problem persists, please call our Consumer Services Department at 1-800-521-2010 in the U.S. or 1-800-267-7377 in Canada.

# ASSEMBLY INSTRUCTION - PLAY AS A GYM

1. Insert the left leg to the left base. Tighten the big green screw on the base to the leg.

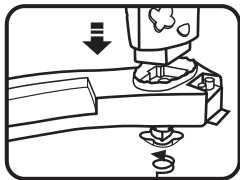

2. Repeat steps 1 for the right side.

3. Place the gym on a flat surface. Link up the right and left base with the bridge as shown in the picture.

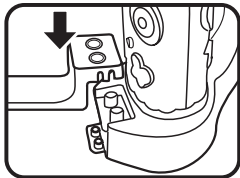
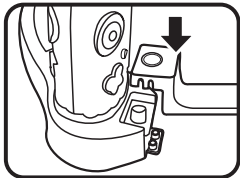

4. Insert the left leg to the left back side of the main board. Tighten the big green screw on the leg to the main board. Then, repeat the steps for the right side.

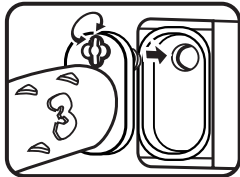

5. Place the soft bumper with the elephant on the left base. Insert the left base into the soft bumper, and then attach the soft bumper with the velcro. Place the soft bumper with the bear on the right base. Insert the right base into the soft bumper, and then attach the soft bumper with the velcro.

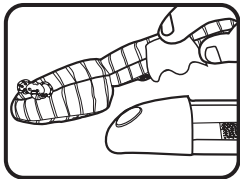

6. Hang the three detachable animals to the gym. Each animal has a color coded velcro strap. Match the color of the velcro strap to the hanging slip at the bottom of the main board. If the animals are not hung correctly you will hear the wrong response during the game play.

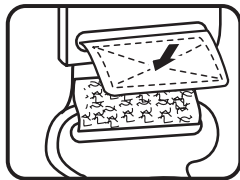

**REMINDER:** Please note to make sure that the screws are tightened for stable play. Please note that the gym should be placed on a flat surface only.

## **ASSEMBLY INSTRUCTION- PLAY AS A CRIB TOY**

1. To attach to the crib, please make sure that the legs, base, and bridge are disconnected from the unit. Insert the yellow straps to the back of main board as the picture shown.

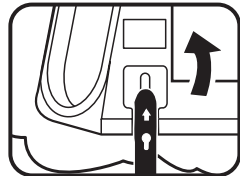

2. Make sure the straps are balanced and hang them on the crib securely.

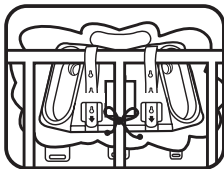

## IMPORTANT SAFETY NOTICE:

Please make sure the straps are out of reach from children.

## TO BEGIN PLAY

1. Slide the **PLAYTIME/OFF/SOOTHING MODE SELECTOR SWITCH** to the **PLAYTIME MODE** (☀️) or **SOOTHING MODE** (☾) position to turn the unit **ON**. You will hear a short tune. The **LIGHT-UP MANE** will flash with the sound.
2. To adjust the volume, slide the **HIGH / LOW VOLUME CONTROL SWITCH** to the (🔊) position for **HIGH VOLUME** or the (🔇) position for **LOW VOLUME**.
3. Slide the **PLAYTIME/OFF/SOOTHING MODE SELECTOR SWITCH** to the **OFF** (●) position to turn the unit **OFF**.

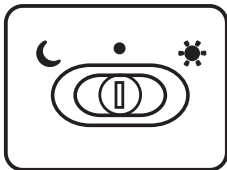
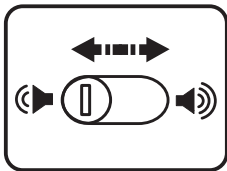
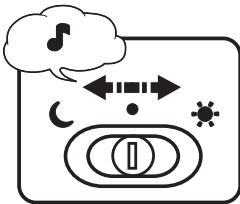

**Note:** The **VTech® Safari Gym™** will automatically turn off after several seconds without input. The unit can be turned on again by activating any button.

## ACTIVITIES

### PLAYTIME MODE

1. Turn on the unit by sliding the **PLAYTIME/OFF/SOOTHING MODE SELECTOR SWITCH** to the **PLAYTIME MODE** position (☀️). You will hear a short tune. The **LIGHT-UP MANE** will flash with the sound.

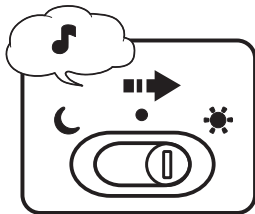

2. Push the **PARROT** for the first time to hear a parrot sound effect and “ABC!” Push the **PARROT** a second time to hear a parrot sound effect and “Baby want to play!” Push the **PARROT** a third time to hear a melody. The **LIGHT-UP MANE** will flash with the sound.

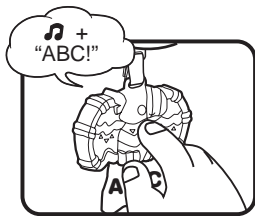

3. Push the **BUTTERFLY** for the first time to hear a drum sound effect. Push the **BUTTERFLY** a second time to hear “Up, up, up!” and a giggle sound effect. Push the **BUTTERFLY** a third time to hear a melody. The **LIGHT-UP MANE** will flash with the sound.

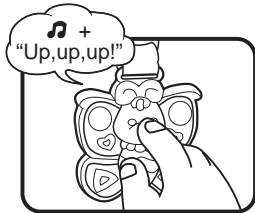



4. Push the **MONKEY** for the first time to hear a monkey sound effect and "123!" Push the **MONKEY** a second time to hear a monkey sound effect and "Wheee!" Push the **MONKEY** a third time to hear a melody. The **LIGHT-UP MANE** will flash with the sound.



5. Press on the **BEAR** for the first time to hear a giggle sound effect and "I see baby!" Press on the **BEAR** a second time to hear a melody. The **LIGHT-UP MANE** will flash with the sound.

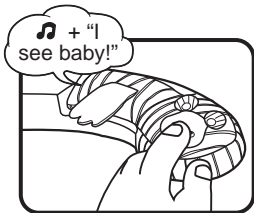

6. Press on the **ELEPHANT** for the first time to hear an elephant sound effect and "Where's baby!" Press on the **ELEPHANT** a second time to hear a melody. The **LIGHT-UP MANE** will flash with the sound.

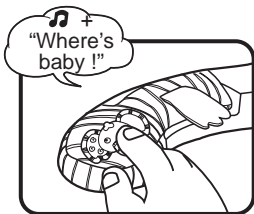

7. Activate the **PROXIMITY SENSOR** to hear random sound effects. You will hear random sound effect add on per each activation (drum, parrot, monkey, elephant). The **LIGHT-UP MANE** will flash with the sound.

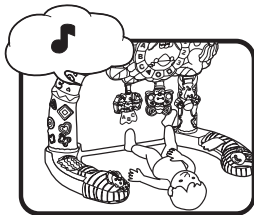

8. Activate any character or the **PROXIMITY SENSOR** while a melody or short tune is playing to hear the corresponding sound effect play over the melody or short tune. The **LIGHT-UP MANE** will flash with the sound.

## SOOTHING MODE

1. Turn on the unit by sliding the **PLAYTIME/OFF/SOOTHING MODE SELECTOR SWITCH** to the **SOOTHING MODE** (☾). You will hear a soothing short tune. The **LIGHT-UP MANE** will flash with the sound.

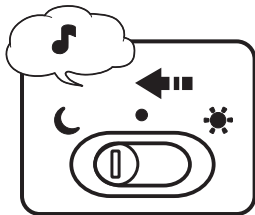

2. Push the **PARROT** to hear a soothing melody or parrot sound effect. The **LIGHT-UP MANE** will flash with the sound.

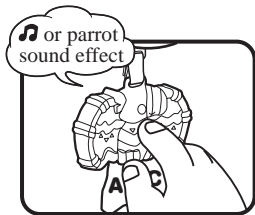

3. Push the **BUTTERFLY** to hear a soothing melody or drum sound effect. The **LIGHT-UP MANE** will flash with the sound.

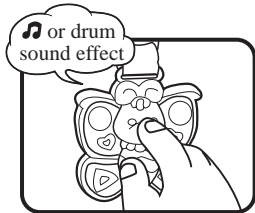

4. Push the **MONKEY** to hear a soothing melody or monkey sound effect. The **LIGHT-UP MANE** will flash with the sound.

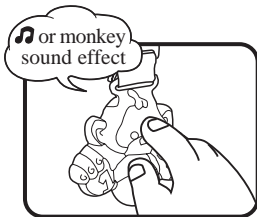

5. Press on the **BEAR** to hear a soothing melody or giggle sound effect. The **LIGHT-UP MANE** will flash with the sound.

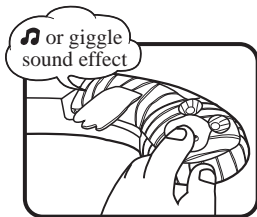

6. Press on the **ELEPHANT** to hear a soothing melody or elephant sound effect. The **LIGHT-UP MANE** will flash with the sound.

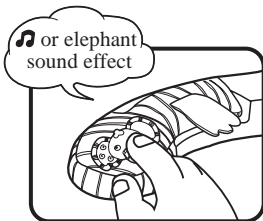

7. Activate the **PROXIMITY SENSOR** to hear a soothing sound effect and a soothing melody. The melodies will continue on to play for approximately 5 minutes. The **LIGHT-UP MANE** will flash with the sound.

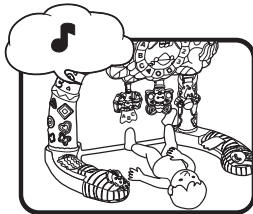

8. Activate any character or the **PROXIMITY SENSOR** while a melody or short tune is playing to hear the corresponding sound effect play over the melody or short tune. The **LIGHT-UP MANE** will flash with the sound.

## PLAYTIME MELODIES

- Happy Farmer
- Nutcracker Suite
- Rondo Alla Turca
- Ring Around the Rosie
- Are You Sleeping

## SOOTHING MELODIES

- Rock-A-Bye Baby
- Ode To Joy
- Largo
- Air for the G String
- Lullaby

## CARE AND MAINTENANCE

1. Keep the unit clean by wiping it with a slightly damp cloth.
2. Keep the unit away from direct sunlight and heat source.
3. Remove the batteries when the unit is not in use for an extended period of time.
4. Do not drop the unit on hard surfaces and do not expose the unit to moisture or water.

5. Please note that only the bumpers on this product are machine washable. These pieces can be machine washed separately on a gentle cycle with cold water. Allow them to drip dry. Do not tumble dry. Please note that repeated washings may cause slight color fading over time.

### **IMPORTANT NOTE**

Creating and developing infant/toddler products is accompanied by a responsibility that we at **VTech**<sup>®</sup> take very seriously. We make every effort to ensure the accuracy of the information, which forms the value of our products. However, errors sometimes occur. It is important for you to know that we stand behind our products and encourage you to call our Consumer Services Department at 1-800-521-2010 in the U.S. or 1-800-267-7377 in Canada with any problems and/or suggestions that you might have. Our service representative will be happy to help you.

### **NOTE:**

This equipment generates and uses radio frequency energy and if not installed and used properly, that is, in strict accordance with the manufacturer's instructions, it may cause interference to radio and television reception. It has been type tested and found to comply within the limits for a Class B computing device in accordance with the specifications in Sub-part J of Part 15 FCC Rules, which are designed to provide reasonable protection against such interference in a residential installation. However, there is no guarantee that interference will not occur in a particular installation. If this equipment does cause interference with radio or television reception, which can be determined by turning the equipment off and on, the user is encouraged to try to correct the interference by one or more of the following measure:

- reorient the receiving antenna
- relocate this product with respect to the receiver
- move this product away from the receiver