

Soft Singing Moon™

User's Manual

BATTERY INSTALLATION

1. Make sure the unit is turned **OFF**.
2. Locate the battery cover on the back of the unit. Use a coin or a screwdriver to loosen the screw.
3. Install 2 new 'AAA' (UM4/LR03) batteries following the diagram inside the battery box.
4. Replace the battery cover and tighten the screw to secure.

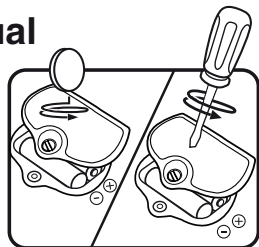

BATTERY NOTICE

- Install batteries correctly observing the polarity (+, -) signs to avoid leakage.
- Do not mix old and new batteries.
- Do not mix batteries of different types: alkaline, standard (carbon-zinc) or rechargeable (nickel-cadmium).
- Remove the batteries from the equipment when the unit will not be used for an extended period of time.
- Always remove exhausted batteries from the equipment.
- Do not dispose of batteries in fire.
- Do not attempt to recharge ordinary batteries.
- The supply terminals are not to be short-circuited.
- Only batteries of the same and equivalent type as recommended are to be used.

WE DO NOT RECOMMEND THE USE OF RECHARGEABLE BATTERIES.

INCLUDED IN THIS PACKAGE

- One VTech® Soft Singing Moon™
- One crib attachment strap
- One instruction manual

CRIB ATTACHMENT

CAUTION:

TO ENSURE YOUR CHILD'S SAFETY, THIS PRODUCT MUST BE ASSEMBLED BY AN ADULT.

The crib attachment strap allows for easy and secure mounting of the VTech® Soft Singing Moon™ to a crib. Please follow the instructions carefully and make sure the final assembly is correct. Attach only to cribs with sturdy rails and spindles. Do not attach to playpens with mesh walls.

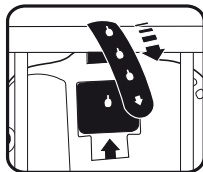

①

1. Place the unit in the crib, bringing the strap over the top rail. Slip the top of the strap under the slot on the back of the unit and secure. You can adjust the hanging height by choosing the appropriate hole on the top of the strap. Tie the string securely to the nearest spindle.
2. Pull slightly on the unit to make sure the strap has been securely fastened. The unit should be snug against the crib rail.
3. For your child's safety, please ensure that the crib attachment strap has been removed when the unit is not hanging in the crib.

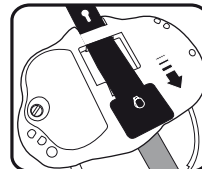
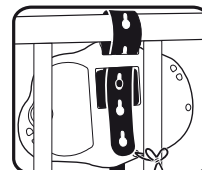

PRODUCT FEATURES

1. ON/OFF/MODE SELECTOR SWITCH

To turn the unit **ON**, slide the **ON/OFF/MODE SELECTOR SWITCH** to the **PLAY MODE** (☀️) or the **SLEEP MODE** (🌙) position. To turn the unit **OFF**, slide the **ON/OFF/MODE SELECTOR SWITCH** to the **OFF** (●) position.

2. VOLUME CONTROL SWITCH

To adjust the volume, slide the **VOLUME CONTROL SWITCH** to the **LOW VOLUME** (🔊) or the **HIGH VOLUME** (🔊) position.

3. AUTOMATIC SHUT-OFF

After several seconds without input, the VTech® Soft Singing Moon™ will automatically power-down. The unit can be turned on again by pulling on the bear.

ACTIVITIES

1. Slide the **on/off/mode selector switch** to turn the unit on. You will hear a song and phrase to greet you. The light will flash with the sound.
2. Pull on the **bear** in the play mode to hear playful phrases, fun sounds and songs. The light will flash with the sound, and the moon will rock back and forth.
3. Pull on the **bear** in the sleep mode to hear soothing phrases and melodies. The light will fade in and out with the sound and the moon will rock back and forth.

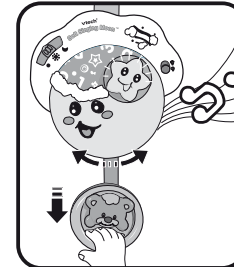
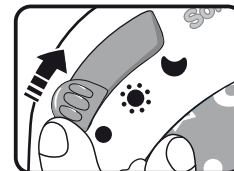

②

MELODY LIST

1. Here We Go Round the Mulberry Bush
2. Old MacDonald Had a Farm
3. Hickory Dickory Dock
4. I've Been Working on the Railroad
5. Rock-a-bye Baby
6. Hush Little Baby
7. Moonlight Sonata
8. Old King Cole
9. Brahms' Lullaby
10. Twinkle, Twinkle, Little Star
11. Beautiful Dreamer
12. Fur Elise

SONG LYRICS

Song 1 (To tune of "Twinkle, Twinkle, Little Star")

Twinkling stars come out at night.
I'm the moon, I shine so bright.

Song 2 (To tune of "Row, Row, Row Your Boat")

Come on, play with me,
We'll learn 1-2-3.
Sing and learn and play all day,
Happy as can be.

Song 3

Now let's see what we can explore,
Numbers, sounds and so much more!

CARE AND MAINTENANCE

1. Keep the unit clean by wiping it with a slightly damp cloth.
2. Keep the unit out of direct sunlight and away from any direct heat source.
3. Remove the batteries when the unit is not in use for an extended period of time.
4. Do not drop the unit on hard surfaces and do not expose the unit to moisture or water.

TROUBLESHOOTING

If for some reason the program/activity stops working or malfunctions, please follow these steps:

1. Please turn the unit **OFF**.

2. Interrupt the power supply by removing the batteries.
3. Let the unit stand for a few minutes, then replace the batteries.
4. Turn the unit **ON**. The unit should now be ready to play again.
5. If the product still does not work, replace with an entire set of new batteries.

If the problem persists, please call our Consumer Services Department at 1-800-521-2010 in the U.S. or 1-877-352-8697 in Canada, and a service representative will be happy to help you.

For information on this product's warranty, please call **VTech®** at 1-800-521-2010 in the U.S. or 1-877-352-8697.

Note:

This equipment has been tested and found to comply with the limits for a Class B digital device, pursuant to Part 15 of the FCC Rules. These limits are designed to provide reasonable protection against harmful interference in a residential installation. This equipment generates, uses and can radiate radio frequency energy and, if not installed and used in accordance with the instructions, may cause harmful interference to radio communications. However, there is no guarantee that interference will not occur in a particular installation. If this equipment does cause harmful interference to radio or television reception, which can be determined by turning the equipment off and on, the user is encouraged to try to correct the interference by one or more of the following measures:

- Reorient or relocate the receiving antenna
- Increase the separation between the equipment and receiver
- Connect the equipment into an outlet on a circuit different from that to which the receiver is connected
- Consult the dealer or an experienced radio/TV technician for help

THIS DEVICE COMPLIES WITH PART 15 OF THE FCC RULES. OPERATION IS SUBJECT TO THE FOLLOWING TWO CONDITIONS: (1) THIS DEVICE MAY NOT CAUSE HARMFUL INTERFERENCE, AND (2) THIS DEVICE MUST ACCEPT ANY INTERFERENCE RECEIVED, INCLUDING INTERFERENCE THAT MAY CAUSE UNDESIRE OPERATION.

THIS CLASS B DIGITAL APPARATUS COMPLIES WITH CANADIAN ICES-003.
CET APPAREIL NUMÉRIQUE DE LA CLASSE B EST CONFORME À LA NORME NMB-003 DU CANADA.

Caution: changes or modifications not expressly approved by the party responsible for compliance could void the user's authority to operate the equipment.