

**vtech**<sup>®</sup>

User's Manual

# Light-Up Learning Turtle<sup>™</sup>



© 2010 VTech  
Printed in China  
91-002441-006-000美

Dear Parent,

Ever notice the look on your baby's face when they learn something new through their own discovery? These self-accomplished moments are a parent's greatest reward. To help fulfill them, VTech® created the **Infant Learning**® series of toys.

These unique interactive learning toys directly respond to what children do naturally – play! Using innovative technology, these toys react to baby's interactions, making each play experience fun and unique as they learn age-appropriate concepts like first words, numbers, shapes, colors and music. More importantly, VTech®'s **Infant Learning**® toys develop baby's mental and physical abilities by inspiring, engaging and teaching.

At VTech®, we know that a child has the ability to do great things. That's why all of our electronic learning products are uniquely designed to develop a child's mind and allow them to learn to the best of their ability. We thank you for trusting VTech® with the important job of helping your child learn and grow!

Sincerely,

Your friends at VTech®

To learn more about the **Infant Learning**® series and other VTech® toys, visit [www.vtechkids.com](http://www.vtechkids.com)

# INTRODUCTION

Thank you for purchasing the **VTech® Light-Up Learning Turtle™** bath toy! The **VTech® Light-Up Learning Turtle™** is an interactive toy for little ones to enjoy in the bath! Featuring sea animal pals, it can be played with either in or out of the water. Introduces colours, animals, shapes and music through interactive play. The accessories include pouring and squirting features that add to the fun. With lots of cheerful melodies and songs, having a bath has never been so much fun!

FLASHING LIGHT

ON/OFF BUTTON

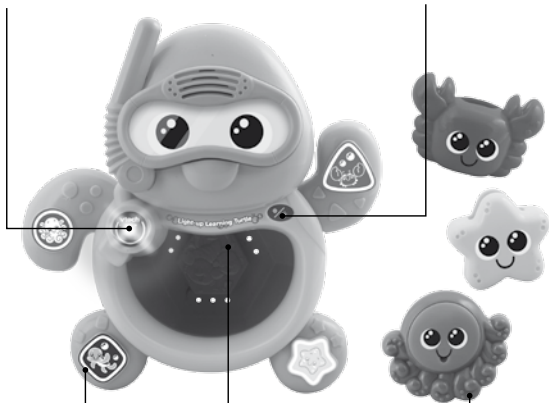

4 ANIMAL/SHAPE  
BUTTONS

WATER SENSOR

3 SEA ANIMALS

# INCLUDED IN THIS PACKAGE

- One VTech® Light-Up Learning Turtle™
- Three sea animals
- One user's manual

**WARNING:** All packing materials, such as tape, plastic sheets, wire ties and tags are not part of this toy, and should be discarded for your child's safety. Please remove the cord and discard before assembly.

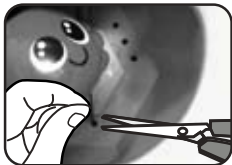

**NOTE:** Please keep this instruction manual as it contains important information.

## GETTING STARTED

### BATTERY INSTALLATION

1. Make sure the unit is turned **OFF** and the battery cover, battery box and unit are all dry.
2. Locate the battery cover on the bottom of the unit. Use a screwdriver to loosen the screw and unlock the fastener.
3. Install 2 new 'AAA' (AM-4/LR03) batteries following the diagram inside the battery box. (The use of new alkaline batteries is recommended for maximum performance.)

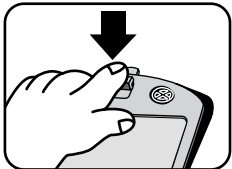

4. Replace the battery cover and tighten the screw to secure and lock the fastener.
5. When closing the battery cover ensure that the screw is securely tightened. This will avoid any water leakage.

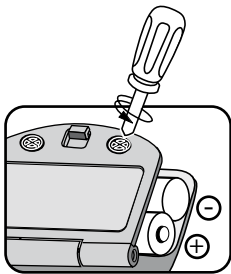

## BATTERY NOTICE

- The use of new alkaline batteries is recommended for maximum performance.
- Non-rechargeable batteries are not to be recharged.
- Rechargeable batteries are to be removed from the toy before being charged (if removable).
- Rechargeable batteries are only to be charged under adult supervision (if removable).
- Different types of batteries or new and used batteries are not to be mixed.
- Only batteries of the same or equivalent type as recommended are to be used.
- Batteries are to be inserted with the correct polarity.
- Exhausted batteries are to be removed from the toy.
- The supply terminals are not to be short-circuited.
- The toy is not to be connected to more than the recommended number of power supplies.
- Do not dispose of batteries in fire.

# PRODUCT FEATURES



## 1. ON/OFF BUTTON

To turn the unit **ON** or **OFF**, press the **ON/OFF BUTTON** (●/⏻)

## 2. AUTOMATIC SHUT-OFF

To preserve battery life, the **VTech® Light-Up Learning Turtle™** will automatically power-down after approximately 30 seconds without input. The unit can be turned on again by pressing any button.

**Please note:** When the speaker fills up with water, the volume of the product may decrease. Remove the product from the water and allow the water to drain away from the speaker. Return the product to the water and continue playing.

## WARNING:

- **Batteries must be changed by an adult.**
- **Only use this product in water between 10 and 45 degrees Celsius, 50 and 104 degrees Fahrenheit.**
- **This product cannot be used in salt water.**
- **Do not leave this product submerged in water for a long period of time.**
- **This product should only be operated in water when fully assembled in accordance with the instructions.**
- **To prevent drowning, never leave a child unattended in the bath.**
- **Use a thermometer to check the temperature of the water before sitting a child in the bath. Toddlers have very sensitive skin and can burn easily if the water is too hot.**
- **When finished playing, remove the turtle from the water and pour out any remaining water. Rinse the unit with clean water and wipe with a dry cloth. Suspend the unit in an upright position to dry.**

# ACTIVITIES

1. Press the **on/off button** to turn the unit **on** (☼). You will hear a fun sing-along song and sound effects. The light will flash with the sound.



2. Press the **animal/shape buttons** to hear sound effects, phrases and short tunes. The light will flash with the sound.

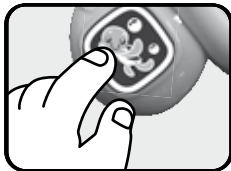

3. Put the turtle into the water or take it out of the water to hear a variety of funny sounds and melodies. Water will drain from the back of the turtle. The light will flash with the sound.

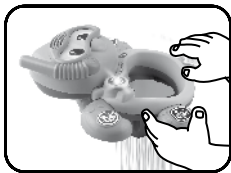

4. Taking the turtle out of the water and dropping the sea animals into the tummy of the turtle will trigger funny sound effects and encouraging phrases. The light will flash with the sound.

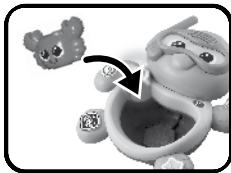

6. The octopus will spray water when squeezed. Submerge the octopus in the water to fill, when removed from the water and squeezed it will spray water.

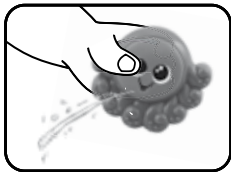

## MELODY LIST

1. Red River Valley
2. Aloha 'Oe
3. Three Little Kittens
4. Ring Around the Rosy
5. Where Has My little Dog Gone?

## SING-ALONG SONG LYRICS

SONG 1 (to the tune of "Alouette")

Little turtle, funny little turtle.

Little turtle, I like to swim!

SONG 2 (to the tune of "London Bridge")

Come, let's play in the water,

With our friends, splash around!

Come, let's play in the water,

We'll have fun!



# CARE & MAINTENANCE

1. Keep the unit clean by wiping it with a slightly damp cloth.
2. Keep the unit out of direct sunlight and away from any direct heat source.
3. Make sure to empty the water out of all the elements of the unit and rinse thoroughly before drying so no sediment or cleaning products are left on the unit.
4. Make sure to dry all the elements of the unit before storing.
5. Remove the batteries when the unit is not in use for an extended period of time.
6. Do not drop the unit on hard surfaces.

# TROUBLESHOOTING

If for some reason the program/activity stops working or malfunctions, please follow these steps:

1. Please turn the unit **OFF**.
2. Interrupt the power supply by removing the batteries.
3. Let the unit stand for a few minutes, then replace the batteries.
4. Turn the unit **ON**. The unit should now be ready to play again.
5. If the product still does not work, replace with a new set of batteries.

If the problem persists, please call our Consumer Services Department at 1-800-521-2010 in the U.S. or 1-877-352-8697 in Canada, and a service representative will be happy to help you.

For information on this product's warranty, please call **VTech**® 1-800-521-2010 in the U.S., or 1-877-352-8697 in Canada.

**IMPORTANT NOTE:**

Creating and developing **Infant Learning** products is accompanied by a responsibility that we at **VTech®** take very seriously. We make every effort to ensure the accuracy of the information, which forms the value of our products. However, errors sometimes can occur. It is important for you to know that we stand behind our products and encourage you to call our Consumer Services Department at 1-800-521-2010 in the U.S., or 1-877-352-8697 in Canada, with any problems and/or suggestions that you might have. A service representative will be happy to help you.

**FCC Notice:**

This equipment has been tested and found to comply with the limits for a Class B digital device, pursuant to Part 15 of the FCC Rules. These limits are designed to provide reasonable protection against harmful interference in a residential installation. This equipment generates, uses and can radiate radio frequency energy and, if not installed and used in accordance with the instructions, may cause harmful interference to radio communications. However, there is no guarantee that interference will not occur in a particular installation. If this equipment does cause harmful interference to radio or television reception, which can be determined by turning the equipment off and on, the user is encouraged to try to correct the interference by one or more of the following measures:

- Reorient or relocate the receiving antenna
- Increase the separation between the equipment and receiver
- Connect the equipment into an outlet on a circuit different from that to which the receiver is connected
- Consult the dealer or an experienced radio/TV technician for help

THIS DEVICE COMPLIES WITH PART 15 OF THE FCC RULES. OPERATION IS SUBJECT TO THE FOLLOWING TWO CONDITIONS: (1) THIS DEVICE MAY NOT CAUSE HARMFUL INTERFERENCE, AND (2) THIS DEVICE MUST ACCEPT ANY INTERFERENCE RECEIVED, INCLUDING INTERFERENCE THAT MAY CAUSE UNDESIREED OPERATION.

THIS CLASS B DIGITAL APPARATUS COMPLIES WITH CANADIAN ICES- 003.

CET APPAREIL NUMÉRIQUE DE LA CLASSE B EST CONFORME À LA NORME NMB-003 DU CANADA.

**Caution:** Changes or modifications not expressly approved by the party responsible for compliance could void the user's authority to operate the equipment.

