

vtech[®]

User's Manual

Spin & Learn Color Carousel™



© 2014 VTech
Printed in China
91-002900-000 

Dear Parent,

Ever notice the look on your baby's face when they learn something new through their own discovery? These self-accomplished moments are a parent's greatest reward. To help fulfill them, **VTech**[®] created the **Infant Learning**[®] series of toys.

These unique interactive learning toys directly respond to what children do naturally – play! Using innovative technology, these toys react to baby's interactions, making each play experience fun and unique as they learn age-appropriate concepts like first words, numbers, shapes, colors and music. More importantly, **VTech**[®]'s **Infant Learning**[®] toys develop baby's mental and physical abilities by inspiring, engaging and teaching.

At **VTech**[®], we know that a child has the ability to do great things. That's why all of our electronic learning products are uniquely designed to develop a child's mind and allow them to learn to the best of their ability. We thank you for trusting **VTech**[®] with the important job of helping your child learn and grow!

Sincerely,

Your friends at **VTech**[®]

To learn more about the **Infant Learning**[®] series and other **VTech**[®] toys, visit www.vtechkids.com

INTRODUCTION

Thank you for purchasing the **VTech® Spin & Learn Color Carousel™**. Explore colors, counting and more with the **Spin & Learn Color Carousel™** by **VTech®**. Four animal friends and three press buttons engage children and help them learn. Press the chunky button on the top of the carousel to set the animals in motion and watch them go.

CAROUSEL BUTTON

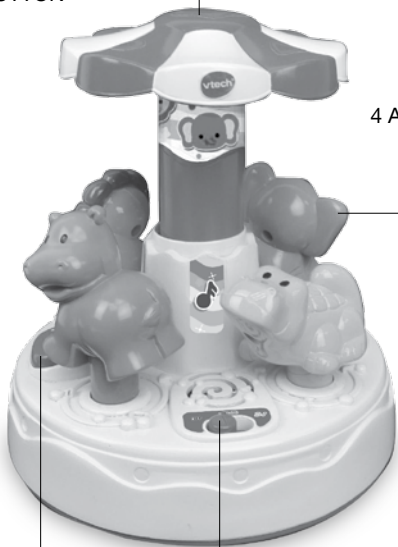

4 ANIMALS

ACTIVITY BUTTONS

ON/OFF/MODE SELECTOR SWITCH

INCLUDED IN THIS PACKAGE

- One VTech® Spin & Learn Color Carousel™
- One user's manual

WARNING: All packing materials, such as tape, plastic sheets, wire ties and tags are not part of this toy, and should be discarded for your child's safety.

ATTENTION: Pour la sécurité de votre enfant, débarrassez-vous de tous les produits d'emballage tels que. rubans adhésifs, feuilles de plastique, attaches et étiquettes. Ils ne font pas partie du jouet.

NOTE: Please keep user's manual as it contains important information.

GETTING STARTED

BATTERY INSTALLATION

1. Make sure the unit is turned **OFF**.
2. Install 2 new 'AAA' (UM-3/LR6) batteries following the diagram inside the battery box. (The use of new alkaline batteries is recommended for maximum performance.)
3. Replace the battery cover and tighten the screw to secure.

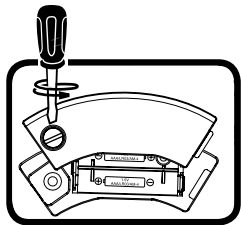

BATTERY NOTICE

- Use new alkaline batteries for maximum performance.
- Use only batteries of the same or equivalent type as recommended.

- Do not mix different types of batteries: alkaline, standard (carbon-zinc) or rechargeable (Ni-Cd, Ni-MH), or new and used batteries.
- Do not use damaged batteries.
- Insert batteries with the correct polarity.
- Do not short-circuit the battery terminals.
- Remove exhausted batteries from the toy.
- Remove batteries during long periods of non-use.
- Do not dispose of batteries in fire.
- Do not charge non-rechargeable batteries.
- Remove rechargeable batteries from the toy before charging (if removable).
- Rechargeable batteries are only to be charged under adult supervision.

PRODUCT FEATURES

1. ON/OFF/MODE SELECTOR SWITCH

To turn the unit **ON**, slide the **ON/OFF/MODE SELECTOR SWITCH** to the **ANIMAL MODE** (🐾🐾) or the **MUSIC MODE** (🎵🎵) position. To turn the unit **OFF**, slide the **ON/OFF/MODE SELECTOR SWITCH** to the **OFF** position.

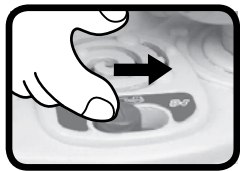

2. VOLUME CONTROL SWITCH

To adjust the volume, slide the **VOLUME CONTROL SWITCH** to the **LOW VOLUME** (🔊) or **HIGH VOLUME** (🔊) position.

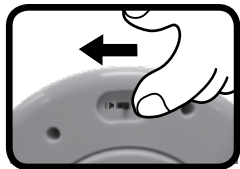

3. AUTOMATIC SHUT-OFF

To preserve battery life, the **VTech® Spin & Learn Color Carousel™** will automatically power-down after approximately 60 seconds without input. The unit can be turned on again by pressing any button.

ACTIVITIES

1. Slide the **on/off/mode selector switch** to turn the unit on and select a mode of play. You will hear a playful song, phrase and sound in the animal mode and a playful sound and song in the music mode. The light will flash with the sounds.
2. Press the **animal buttons** in the animal mode to learn colors, animal names, fun facts and hear animal sounds. In the music mode you will hear animal sounds and playful tunes. The light will flash with the sounds.
3. Press the **question button** to answer simple questions about the animals. The light will flash with the sounds.



4. Press the **number button** in the animal mode to learn to about numbers. Press the animal buttons after the number button has been pressed to count the animals. In the music mode you will hear a variety of short tunes. The light will flash with the sounds.



5. Press the **music button** in the animal mode to hear one of two songs. In the music mode you will hear a random melody. The light will flash with the sounds.



6. Press the **carousel button** to spin the carousel. You will hear playful phrases and sounds in the animal mode and hear fun sounds and random melodies in the music mode. The light will flash with the sounds.



SUNG SONG LYRICS

SONG 1

Round and round the animals go,
Spinning and singing as they go!

SONG 2

A rainbow of colors is spinning all around.
Red, orange, yellow, green and blue.

MELODY LIST:

1. Animal Fair
2. Daring Young Man on the Flying Trapeze
3. Toyland
4. Ring Around the Rosy
5. Sing a Song of Sixpence
6. Listen to the Mockingbird
7. Big Rock Candy Mountain
8. Alouette
9. Here We Go Round the Mulberry Bush
10. Aiken Drum
11. Down By The Riverside
12. Froggy Went a Courtin'
13. Yankee Doodle
14. For He's a Jolly Good Fellow
15. One, Two, Buckle My Shoe
16. Green Grass Grew All Around
17. Pineapple Rag
18. Entertainer
19. On Top of Old Smokey

CARE & MAINTENANCE

1. Keep the unit clean by wiping it with a slightly damp cloth.
2. Keep the unit out of direct sunlight and away from any direct heat source.
3. Remove the batteries when the unit will not be in use for an extended period of time.
4. Do not drop the unit on hard surfaces and do not expose the unit to moisture or water.

TROUBLESHOOTING

If for some reason the program/activity stops working or malfunctions, please follow these steps:

1. Please turn the unit **OFF**.
2. Interrupt the power supply by removing the batteries.
3. Let the unit stand for a few minutes, then replace the batteries.
4. Turn the unit **ON**. The unit should now be ready to play again.
5. If the product still does not work, replace with an entire set of new batteries.

If the problem persists, please call our Consumer Services Department at 1-800-521-2010 in the US. or 1-877-352-8697 in Canada and a service representative will be happy to help you.

IMPORTANT NOTE:

Creating and developing **VTech**[®] products is accompanied by a responsibility that we at **VTech**[®] take very seriously. We make every effort to ensure the accuracy of the information, which forms the value of our products. However, errors sometimes can occur. It is important for you to know that we stand behind our products and encourage you to call our Consumer Services Department at 1-800-521-2010 in the US. or 1-877-352-8697 in Canada. with any problems and/or suggestions that you might have. A service representative will be happy to help you.

Note:

This equipment has been tested and found to comply with the limits for a Class B digital device, pursuant to Part 15 of the FCC Rules. These limits are designed to provide reasonable protection against harmful interference in a residential installation. This equipment generates, uses and can radiate radio frequency energy and, if not installed and used in accordance with the instructions, may cause harmful interference to radio communications. However, there is no guarantee that interference will not occur in a particular installation. If this equipment does cause harmful interference to radio or television reception, which can be determined by turning the equipment off and on, the user is encouraged

to try to correct the interference by one or more of the following measures:

- Reorient or relocate the receiving antenna
- Increase the separation between the equipment and receiver
- Connect the equipment into an outlet on a circuit different from that to which the receiver is connected
- Consult the dealer or an experienced radio/TV technician for help