

**vtech**<sup>®</sup>

Parent's Guide

# Crazy Legs Learning Bugs™



91-003676-000 (US) (CAN)

# INTRODUCTION

Thank you for purchasing the **Crazy Legs Learning Bugs™**. These bugs are crawling with fun! Four shape buttons introduce numbers, shapes and nature facts. Insert shapes onto Mommy Bug's back and press down on Baby Bug to pop them out again. The toy's rolling design promotes crawling and walking.

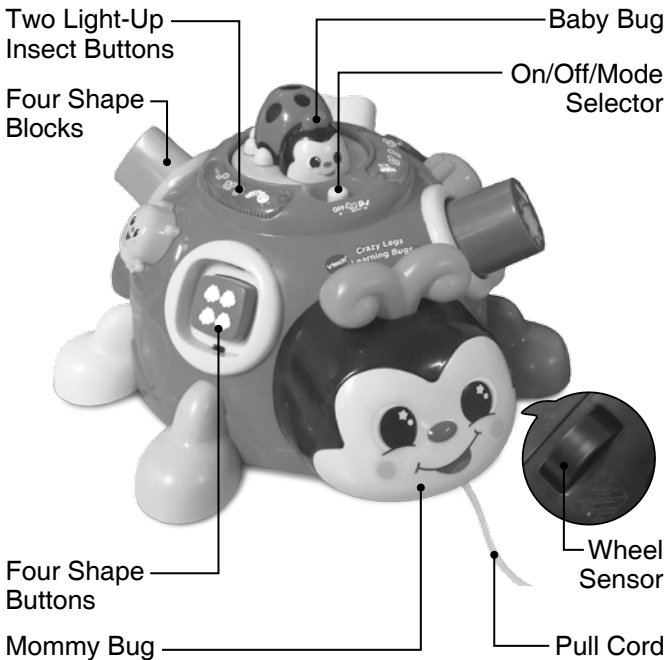

# INCLUDED IN THIS PACKAGE

- One Crazy Legs Learning Bugs™
- One parent's guide



- One Baby Bug



- Four shape sorter blocks

## WARNING:

All packing materials, such as tape, plastic sheets, packaging locks, removable tags, cable ties and packaging screws are not part of this toy, and should be discarded for your child's safety.

## NOTE:

Please keep this parent's guide as it contains important information.

## ATTENTION :

Pour la sécurité de votre enfant, débarrassez-vous de tous les produits d'emballage tels que rubans adhésifs, feuilles de plastique, attaches, étiquettes et vis d'emballage. Ils ne font pas partie du jouet.

## NOTE :

Il est conseillé de conserver ce guide des parents car il comporte des informations importantes.

## Unlock the packaging locks:

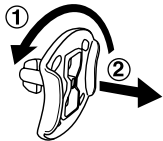

- ① Rotate the packaging lock counterclockwise 90 degrees.
- ② Pull out and discard the packaging lock.

# GETTING STARTED

## BATTERY INSTALLATION

1. Make sure the unit is turned **OFF**.
2. Locate the battery cover on the bottom of the unit. Use a screwdriver to loosen the screw.
3. Install 2 new AA (LR6/AM-3) batteries following the diagram inside the battery box. (The use of new alkaline batteries is recommended for maximum performance.)
4. Replace the battery cover and tighten the screw to secure.

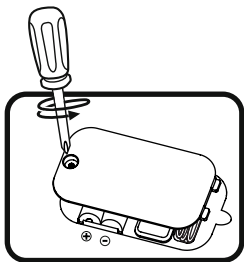

## BATTERY NOTICE

- Use new alkaline batteries for maximum performance.
- Use only batteries of the same or equivalent type as recommended.
- Do not mix different types of batteries: alkaline, standard (carbon-zinc) or rechargeable, or new and used batteries.
- Do not use damaged batteries.
- Insert batteries with the correct polarity.
- Do not short-circuit the battery terminals.
- Remove exhausted batteries from the toy.
- Remove batteries during long periods of non-use.
- Do not dispose of batteries in fire.
- Do not charge non-rechargeable batteries.
- Remove rechargeable batteries from the toy before charging (if removable).
- Rechargeable batteries are only to be charged under adult supervision.

With the **Crazy Legs Learning Bugs™** safety comes first:

1. To ensure your child's safety, adult assembly of this product is required.
2. Please ensure that the Baby Bug is locked into position before giving this toy to a child.



## ASSEMBLY INSTRUCTIONS

1. Please remove the Baby Bug label and the two pieces of clear plastic beneath it to expose the hole in the unit. Discard the label and plastic insert for your child's safety.
2. Align the bottom of the Baby Bug with the hole in the unit. Push the Baby Bug into the hole until it clicks into place. Once the Baby Bug is connected to the Mommy Bug, it cannot be detached.



## PRODUCT FEATURES

### 1. On/Off/Mode Selector

To turn the unit **On**, slide the **On/Off/Mode** selector to the Learning mode  or the Music mode  position. To turn the unit **Off**, slide the **On/Off/Mode** selector to the **Off** position.



## 2. Pull Cord

To convert the unit from a push toy to a pull toy, remove the **pull cord** from the battery compartment and thread it through the eyelet on the bottom of the bug. For your child's safety, please store the pull cord in the compartment until your child is walking.

(Adult supervision is recommended.)

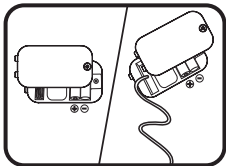

## 3. Automatic Shut Off

To preserve battery life, the **Crazy Legs Learning Bugs™** will automatically power down after approximately 30 seconds without input. The unit can be turned on again by pressing any button. Pulling the unit will not turn the unit back on.

**NOTE:** If the unit powers down during play, we suggest changing the batteries.

# ACTIVITIES

## 1. Shape Buttons

Press the **Shape Buttons** or insert a **Shape Block** to learn the names and colors of the shapes, nature objects and numbers in Learning mode. In Music mode, listen to short tunes and playful melodies. The lights flash with the sounds.

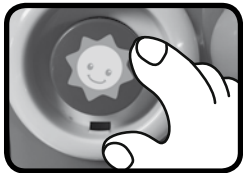

## 2. Baby Bug

Press the **Baby Bug** to hear playful phrases and fun sounds in Learning mode. In Music mode, listen to songs and a variety of melodies. Pressing down on the **Baby Bug** releases the shape blocks that are inserted in the Mommy Bug's back.



### 3. Light-Up Insect Buttons

Press the **Light-Up Insect Buttons** to learn about the insects in Learning mode and to hear cheerful tunes and melodies in Music mode. Watch the lights flash with the sounds.

### 4. Wheel Sensor

Push or pull the Mommy Bug to activate the **Wheel Sensor** and hear a variety of melodies, sounds and songs. As the bug moves along, lights flash with the sounds.



## SONG LYRICS

### Song 1

I am a friendly ladybug.  
My back carries lots of shapes.  
It's fun to explore with my little one,  
Won't you come and have some fun.

### Song 2

When our travels are long,  
It's great to sing a song.  
Come on, won't you sing along!

## MELODY LIST

1. Au Clair de la Lune
2. Flight of the Bumblebee
3. Alouette
4. Oh My Darling, Clementine
5. The Happy Farmer
6. Home on the Range

7. Bingo
8. The Farmer in the Dell
9. Old MacDonald Had a Farm
10. Oh! Susanna
11. Froggie Went A-Courtin'
12. Aiken Drum
13. Mary Had a Little Lamb
14. I've Been Working on the Railroad
15. Hickory Dickory Dock

## CARE & MAINTENANCE

1. Keep the unit clean by wiping it with a slightly damp cloth.
2. Keep the unit out of direct sunlight and away from any heat direct heat sources.
3. Remove the batteries when the unit is not in use for an extended period of time.
4. Do not drop the unit on a hard surface and do not expose the unit to excess moisture.

## TROUBLESHOOTING

If for some reason the unit stops working, please follow these steps:

1. Turn the unit **OFF**.
2. Interrupt the power supply by removing the batteries.
3. Let the unit stand for a few minutes, then replace the batteries.
4. Turn the unit back **ON**. The unit will now be ready to play again.
5. If the unit still does not work, replace with an entire set of new batteries.

If the problem persists, please call our Consumer Services Department at 1-800-521-2010 in the U.S. or 1-877-352-8697 in Canada, or by going to our website at [vtechkids.com](http://vtechkids.com) and filling out our Contact Us form located under the Customer Support link. A service representative will be happy to help you.



**IMPORTANT NOTE:**

Creating and developing **VTech®** products is accompanied by a responsibility that we at **VTech®** take very seriously. We make every effort to ensure the accuracy of the information, which forms the value of our products. However, errors sometimes can occur. It is important for you to know that we stand behind our products and encourage you to call our Consumer Services Department at 1-800-521-2010 in the U.S. or 1-877-352-8697 in Canada, or by going to our website at [vtechkids.com](http://vtechkids.com) and filling out our Contact Us form located under the Customer Support link with any problems and/or suggestions that you might have. A service representative will be happy to help you.

**Note:**

This equipment has been tested and found to comply with the limits for a Class B digital device, pursuant to Part 15 of the FCC Rules. These limits are designed to provide reasonable protection against harmful interference in a residential installation. This equipment generates, uses and can radiate radio frequency energy and, if not installed and used in accordance with the instructions, may cause harmful interference to radio communications. However, there is no guarantee that interference will not occur in a particular installation. If this equipment does cause harmful interference to radio or television reception, which can be determined by turning the equipment off and on, the user is encouraged to try to correct the interference by one or more of the following measures:

- Reorient or relocate the receiving antenna.
- Increase the separation between the equipment and receiver.
- Connect the equipment into an outlet on a circuit different from that to which the receiver is connected.
- Consult the dealer or an experienced radio/TV technician for help.

### Supplier's Declaration of Conformity

Trade Name: VTech®  
Model: 5223  
Product Name: Crazy Legs Learning Bugs™  
Responsible Party: VTech Electronics North America, LLC  
Address: 1156 W. Shure Drive, Suite 200,  
Arlington Heights, IL 60004  
Website: vtechkids.com

THIS DEVICE COMPLIES WITH PART 15 OF THE FCC RULES. OPERATION IS SUBJECT TO THE FOLLOWING TWO CONDITIONS: (1) THIS DEVICE MAY NOT CAUSE HARMFUL INTERFERENCE, AND (2) THIS DEVICE MUST ACCEPT ANY INTERFERENCE RECEIVED, INCLUDING INTERFERENCE THAT MAY CAUSE UNDESIRE OPERATION.

*CAN ICES-3 (B)/NMB-3(B)*

**Caution:** Changes or modifications not expressly approved by the party responsible for compliance could void the user's authority to operate the equipment.

**Visit our website for more  
information about our products,  
downloads, resources and more.**

***vtechkids.com***

Read our complete warranty policy online at  
*vtechkids.com/warranty*



TM & © 2019 VTech Holdings Limited.  
All rights reserved.  
**Printed in China.**  
91-003676-000 (US) 