

vtech[®]

User's Manual

Bubbles the Learning Whale™



© 2013 VTech
Printed in China
91-002860-000 US CA

Dear Parent,

*Ever notice the look on your baby's face when they learn something new through their own discovery? These self-accomplished moments are a parent's greatest reward. To help fulfill them, VTech® created the **Infant Learning**® series of toys.*

*These unique interactive learning toys directly respond to what children do naturally – play! Using innovative technology, these toys react to baby's interactions, making each play experience fun and unique as they learn age-appropriate concepts like first words, numbers, shapes, colors and music. More importantly, VTech®'s **Infant Learning**® toys develop baby's mental and physical abilities by inspiring, engaging and teaching.*

At VTech®, we know that a child has the ability to do great things. That's why all of our electronic learning products are uniquely designed to develop a child's mind and allow them to learn to the best of their ability. We thank you for trusting VTech® with the important job of helping your child learn and grow!

Sincerely,

Your friends at VTech®

*To learn more about the **Infant Learning**® series and other VTech® toys, visit www.vtechkids.com*

INTRODUCTION

Thank you for purchasing the **VTech® Bubbles the Learning Whale™** learning toy!

Make bath time a whale of a good time with **Bubbles the Learning Whale™** by **VTech®**! Teach your baby cause and effect relationships, motor skills and early language skills all while playing in the tub. Add a little bubble solution (not included) and watch the bubbles bounce, dance and pop all around. Five cute sea animal buttons and melodies add to the wet and wild fun. Bath time is fun time, so be sure to make a big splash!

SUCTION CUP
SUPPORT UNIT

BUBBLE
SPOUT

VOLUME/
MOTOR
CONTROL
SWITCH

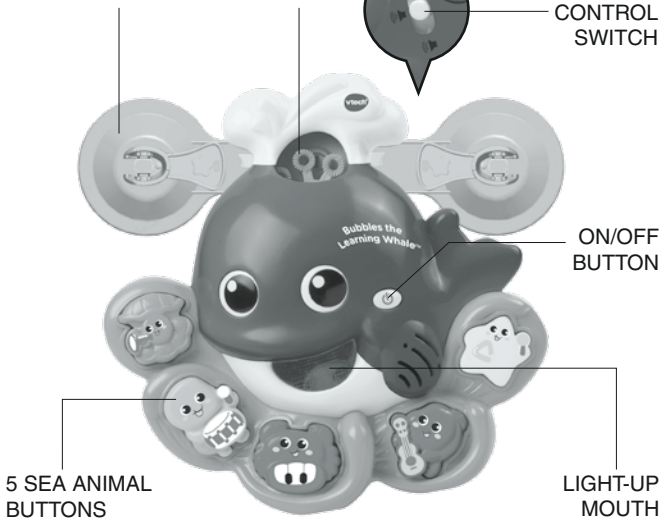

INCLUDED IN THIS PACKAGE

- One VTech® Bubbles the Learning Whale™
- One suction cup support unit
- One instruction manual

WARNING:

All packing materials, such as tape, plastic sheets, packaging locks and tags are not part of this toy, and should be discarded for your child's safety.

ATTENTION:

Pour la sécurité de votre enfant, débarrassez-vous de tous les produits d'emballage tels que rubans adhésifs, feuilles de plastique, attaches et étiquettes. Ils ne font pas partie du jouet.

NOTE:

Please keep this instruction manual as it contains important information.

Unlock the packing locks:

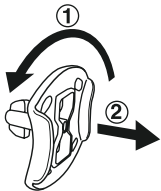

- ① Rotate the packing locks 90 degrees counter-clockwise.
- ② Pull out the packing locks.

INSTRUCTIONS

BATTERY INSTALLATION

1. Make sure the unit is turned **OFF** and the battery cover, battery box and unit are all dry.
2. Locate the battery cover on the back of the unit. Use a screwdriver to loosen the screw.
3. Install 4 new 'AA' (AM-3/LR6) batteries following the diagram inside the battery box. (The use of new alkaline batteries is recommended for maximum performance.)
4. Replace the battery cover and tighten the screw to secure the battery cover. When closing the battery cover ensure that the screws are securely tightened. This will avoid any water leakage.

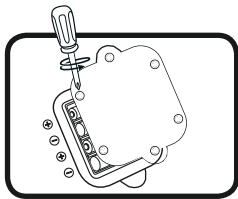

BATTERY NOTICE

- Use new alkaline batteries for maximum performance.
- Use only batteries of the same or equivalent type as recommended.
- Do not mix different types of batteries: alkaline, standard (carbon-zinc) or rechargeable (Ni-Cd, Ni-MH), or new and used batteries.
- Do not use damaged batteries.
- Insert batteries with the correct polarity.
- Do not short-circuit the battery terminals.
- Remove exhausted batteries from the toy.
- Remove batteries during long periods of non-use.
- Do not dispose of batteries in fire.
- Do not charge non-rechargeable batteries.
- Remove rechargeable batteries from the toy before charging (if removable).
- Rechargeable batteries are only to be charged under adult supervision.

PRODUCT ASSEMBLY

With the **VTech® Bubbles the Learning Whale™**, safety comes first. To ensure your child's safety, adult assembly is required.

1. Carefully fill the bubble reservoir with bubble solution. Do not overfill as this may cause the bubble solution to spill. Do not dilute the bubble solution, using concentrated bubble solution will produce the best bubbles (bubble solution not included).
2. Choose a surface on the wall surrounding the tub where the suction cup support unit can be mounted securely. The area should be clean and dry before suctioning the unit to the wall. For better suction, we suggest wetting the suction cups before attaching them to the wall. Press the suction cups onto the wall and flip the tabs out to secure the suction cup support unit. Once the unit is attached to the wall, test the strength of the suction by pulling gently on the unit. The suction cups may not stick properly to textured tiles. We recommend that the unit be removed from the wall after each use as the strength of the suction cups cannot support prolonged use.

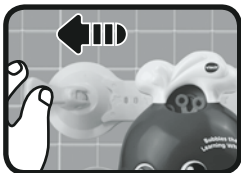
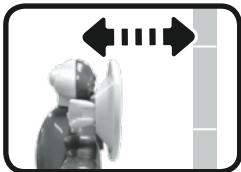

3. To remove the whale from the suction cup support unit, press the release buttons on either side of the bubble spout and pull gently on the whale.

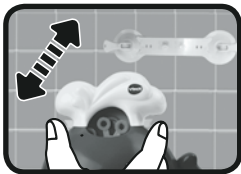

4. To remove the suction cup support unit from the wall, flip the tabs on the suction cup support unit toward the center.

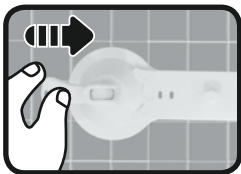

WARNING:

To prevent the risk of injuries, do not attach the VTech® Bubbles the Learning Whale™ any higher than a child's head height when sitting in the bath.

PRODUCT FEATURES

1. ON/OFF BUTTON

To turn the unit **ON**, press the **ON/OFF BUTTON**. To turn the unit **OFF**, press the **ON/OFF BUTTON** a second time.

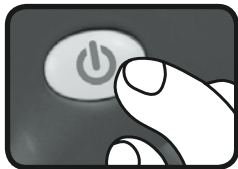

2. VOLUME/MOTOR CONTROL SWITCH

Slide the **VOLUME/MOTOR CONTROL SWITCH** to the **LOW VOLUME** ((▶)) or **HIGH VOLUME** ((◀)) position. To turn off the bubble motor, slide the **VOLUME/MOTOR CONTROL SWITCH** to the **MOTOR OFF** ((⊗)) position.

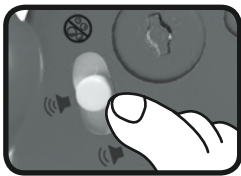

3. AUTOMATIC SHUT-OFF

To preserve battery life, the **VTech® Bubbles the Learning Whale™** will automatically power-down after approximately seven minutes without input. The unit can be turned on again by pressing any button. Please note, sliding the volume/motor control switch will not turn the unit back on.

WARNING:

- Batteries must be changed by an adult.
- We do not recommend submerging the unit in the water. If the unit does get submerged in the water, please dry the unit completely before adding the bubble solution.
- To prevent drowning, never leave a child unattended in the bath.
- Use a thermometer to check the temperature of the water before sitting a child in the bath. Toddlers have very sensitive skin and can burn easily if the water is too hot.
- For best results, use only high quality bubble solution.
- Do not drink the bubble solution.
- In case of eye contact, immediately rinse the eye with clean water.
- Please check the suction cups periodically as they may detach after prolonged use.
- Use caution when handling the unit when the reservoir is full of bubble solution, the bubble solution can spill easily.

- When the unit will not be used for an extended period of time, empty the bubble solution from the reservoir and wipe the unit clean with a damp cloth.
- Children should not play with the suction cups when the unit is fastened to the wall as the unit may detach and cause injuries.
- Do not clean the bubble wand with cleaning products. Cleaners may have a negative impact on the bubble effect.
- Do not touch the bubble wand when the bubble motor is turned on.

ACTIVITIES

1. Press the **on/off button** to turn the unit on. You will hear a fun sound, a playful melody and an introductory phrase. The light will flash and the bubbles will blow with the sound.

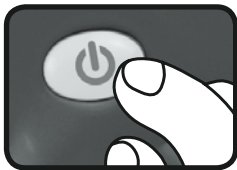

2. Press the **5 sea animal buttons** to hear sing-along songs, playful sounds, animal names, instrument names and melodies. The light will flash and the bubbles will blow with the sound.

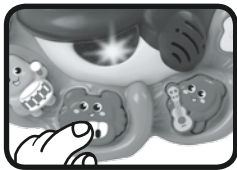

MELODY LIST

1. Sailing, Sailing
2. My Bonnie Lies Over the Ocean
3. Row, Row, Row Your Boat
4. Rub-a-dub-dub
5. Sailor's Hornpipe
6. For He's a Jolly Good Fellow
7. A-Tisket, A-Tasket
8. London Bridge
9. Polly Put the Kettle On
10. Skip To My Lou

SONG LYRICS

SONG 1

Bubbles, bubbles all around.
Popping bubbles up and down.
Bubbles popping to a fro.
Bubbles put on quite a show!

SONG 2

Little green turtle in the sea,
Tapping on his drum, 1-2-3!

SONG 3

The cute little crab likes playing the piano.
Her two big claws move up the scale.

SONG 4

Playful fishy, swimming free,
Plucking and strumming the guitar in the sea.

CARE & MAINTENANCE

1. Remove the unit from the wall after each use.
2. Keep the unit clean by wiping it with a slightly damp cloth.
3. Keep the unit out of direct sunlight and away from any direct heat source.
4. To prevent a build up of residue in the bubble reservoir, rinse the bubble reservoir with warm water.
5. Make sure to dry all the elements of the unit before storing.
6. Remove the batteries when the unit will not be in use for an extended period of time.
7. Do not drop the unit on hard surfaces and do not expose the unit to moisture or water.

TROUBLESHOOTING

If for some reason the program/activity stops working or malfunctions, please follow these steps:

1. Please turn the unit **OFF**.
2. Interrupt the power supply by removing the batteries.
3. Let the unit sit for a few minutes, then replace the batteries.
4. Turn the unit **ON**. The unit should now be ready to play again.
5. If the product still does not work, replace with an entire set of new batteries.

If the problem persists, please call our Consumer Services Department at 1-800-521-2010 in the U.S. or 1-877-352-8697 in Canada, and a service representative will be happy to help you.

For information on this product's warranty, please call VTech® at 1-800-521-2010 in the U.S. or 1-877-352-8697 in Canada.

IMPORTANT NOTE:

Creating and developing **Infant Learning** products is accompanied by a responsibility that we at **VTech®** take very seriously. We make every effort to ensure the accuracy of the information, which forms the value of our products. However, errors sometimes can occur. It is important for you to know that we stand behind our products and encourage you to call our Consumer Services Department at 1-800-521-2010 in the U.S. or 1-877-352-8697 in Canada, with any problems and/or suggestions that you might have. A service representative will be happy to help you.

Note:

This equipment has been tested and found to comply with the limits for a Class B digital device, pursuant to Part 15 of the FCC Rules. These limits are designed to provide reasonable protection against harmful interference in a residential installation. This equipment generates, uses and can radiate radio frequency energy and, if not installed and used in accordance with the instructions, may cause harmful interference to radio communications. However, there is no guarantee that interference will not occur in a particular installation. If this equipment does cause harmful interference to radio or television reception, which can be determined by turning the equipment off and on, the user is encouraged to try to correct the interference by one or more of the following measures:

- Reorient or relocate the receiving antenna
- Increase the separation between the equipment and receiver
- Connect the equipment into an outlet on a circuit different from that to which the receiver is connected
- Consult the dealer or an experienced radio/TV technician for help

Caution: Changes or modifications not expressly approved by the party responsible for compliance could void the user's authority to operate the equipment.

THIS DEVICE COMPLIES WITH PART 15 OF THE FCC RULES. OPERATION IS SUBJECT TO THE FOLLOWING TWO CONDITIONS:
(1) THIS DEVICE MAY NOT CAUSE HARMFUL INTERFERENCE, AND
(2) THIS DEVICE MUST ACCEPT ANY INTERFERENCE RECEIVED, INCLUDING INTERFERENCE THAT MAY CAUSE UNDESIRABLE OPERATION.

CAN ICES-3 (B)/NMB-3(B)



CLASS 1
LED PRODUCT