

vtech[®]

Instruction Manual

Kidi Secrets™ Doodle Pad

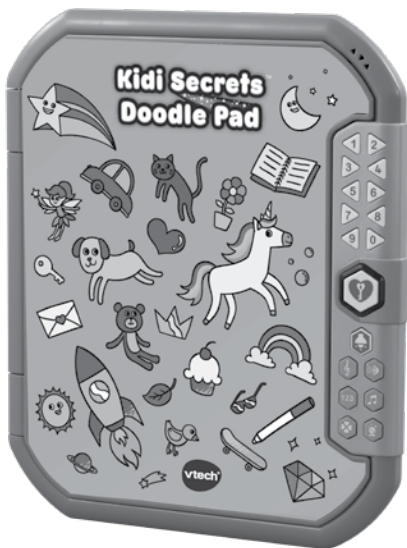

INTRODUCTION

Thank you for purchasing the **Kidi Secrets™ Doodle Pad!**
Draw and doodle anything you can imagine. Grab your art supplies and experiment with colors and art styles on the included art pad, then use the passcode to keep your masterpieces safe. Use the invisible ink marker to add magical, invisible designs to your drawings, then reveal them with the attached light.

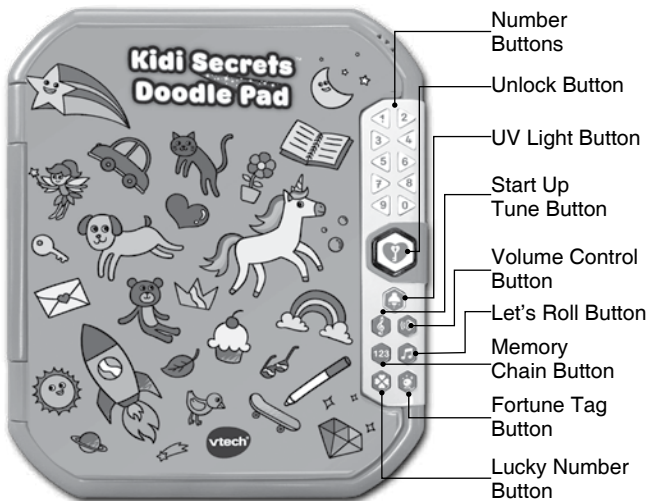

Notebook



Invisible-Ink Pen

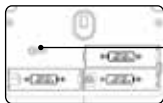

Reset Button
(on the back of the unit)

INCLUDED IN THIS PACKAGE

- One Kidi Secrets™ Doodle Pad
- Quick Start Guide

WARNING

All packing materials such as tape, plastic sheets, packaging locks, removable tags, cable ties, cords and packaging screws are not part of this toy, and should be discarded for your child's safety.

NOTE

Please save this Instruction Manual as it contains important information.

ATTENTION

Pour la sécurité de votre enfant, débarrassez-vous de tous les produits d'emballage tels que rubans adhésifs, feuilles de plastique, attaches, étiquettes, cordons et vis d'emballage. Ils ne font pas partie du jouet. Il est conseillé de conserver ce manuel d'utilisation car il comporte des informations importantes.

NOTE

Il est conseillé de sauvegarder ce manuel d'utilisation car il comporte des informations importantes.

Unlock the Packaging Locks

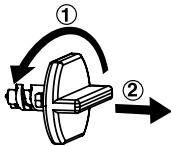

- ① Rotate the packaging locks 90 degrees counterclockwise.
- ② Pull out the packaging locks and discard.

GETTING STARTED

The unit is in Try-Me mode in the packaging. Open the battery cover, then press and hold the reset button for around 1 second, the passcode will be cleared and the notebook cover will open. This confirms that Try-Me mode has been exited.

Battery Removal and Installation

1. Make sure the unit is turned **Off**.
2. Locate the battery cover on the back of the unit. Use a screwdriver to loosen the screw and then open the battery cover.
3. If used batteries are present, remove these batteries from the unit by pulling up on one end of each battery.
4. Install 3 new AA (LR6/AM-3) batteries following the diagram inside the battery box. (For best performance, alkaline batteries or fully charged Ni-MH rechargeable batteries are recommended).
5. Replace the battery cover and tighten the screw to secure.

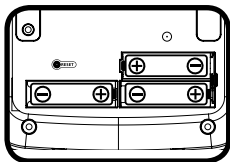
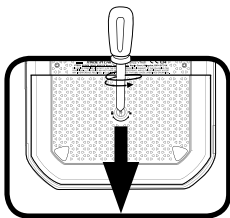

WARNING:

Adult assembly required for battery installation.
Keep batteries out of reach of children.



ATTENTION :

Les piles ou accumulateurs doivent être installés par un adulte.
Tenir les piles ou accumulateurs hors de portée des enfants.

IMPORTANT: BATTERY INFORMATION

- Insert batteries with the correct polarity (+ and -).
- Do not mix old and new batteries.
- Do not mix alkaline, standard (carbon-zinc) or rechargeable batteries.
- Only batteries of the same or equivalent type as recommended are to be used.
- Do not short-circuit the supply terminals.
- Remove batteries during long periods of non-use.
- Remove exhausted batteries from the toy.
- Dispose of batteries safely. Do not dispose of batteries in fire.

RECHARGEABLE BATTERIES

- Remove rechargeable batteries (if removable) from the toy before charging.
- Rechargeable batteries are only to be charged under adult supervision.
- Do not charge non-rechargeable batteries.

IMPORTANT : INFORMATIONS CONCERNANT LES PILES

Les piles fournies avec le produit permettent de tester le jouet en magasin mais ne sont pas des piles longue durée.

- Mettre en place les piles ou les accumulateurs en respectant les polarités + et -.
- Ne pas mélanger des piles ou des accumulateurs neufs avec des usagés.
- Ne pas mélanger différents types de piles : alcalines, zinc-carbone et rechargeables.
- Seules des piles du type recommandé doivent être utilisées.
- Ne pas mettre les bornes d'une pile ou d'un accumulateur en court-circuit (en reliant directement le + et le -).
- Retirer les piles ou les accumulateurs en cas de non-utilisation prolongée.

- Enlever les piles ou les accumulateurs usagés du jouet.
- Ne les jeter ni au feu ni dans la nature.

PILES RECHARGEABLES

- Enlever, lorsque c'est possible, les accumulateurs du jouet pour les recharger.
- Les accumulateurs ne doivent être chargés que sous la surveillance d'un adulte.
- Ne pas tenter de recharger des piles non rechargeables.

PRODUCT FEATURES

1. Unlock Button

Press the **Unlock Button**, then input your number passcode to unlock the unit.

2. Number Buttons

Use to input your number passcode to unlock the unit and play in the related games.



3. UV Light Button

Press the **UV Light Button** to toggle the UV light on and off.

4. Volume Control Button

Press the **Volume Control Button** to toggle between Low and High volume.

5. Start Up Tune Button

Press the **Start Up Tune Button** to enter the mode and press any number buttons to create your own start-up tune.

6. Let's Roll Button

Press the **Let's Roll Button** to enter the mode and hear music.

7. Memory Chain Button

Press the **Memory Chain Button** to enter the mode and play the Memory Chain number game.

8. Lucky Number Button

Press the **Lucky Number Button** to enter the mode and find out your lucky number!

9. Fortune Tag Button

Press the **Fortune Tag Button** to enter the mode and find out your fortune!

10. Reset Button

Press and hold the **Reset Button** for 1-2 seconds to clear the number passcode on the unit. If successful, you will hear “Passcode reset” and the cover will open.



11. Automatic Shut-Off

To preserve battery life, the unit will automatically power-off after several minutes without input. The unit can be turned on again by pressing any button.

12. Notebook Replacement

You can replace the included notebook with a standard A6 size notebook. The maximum recommended page count of a replacement notebook is 100 pages (50 sheets). There are two book holders to secure the replacement notebook. Please make sure that the replacement notebook has been inserted into the two book holders when replacing the notebook.

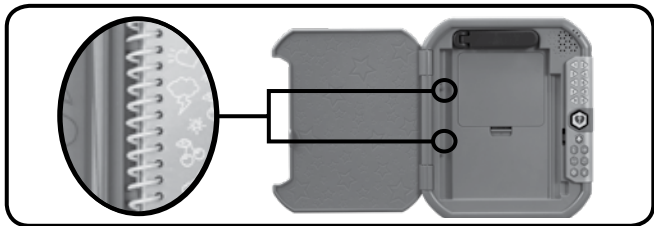

13. Secret Compartment

Store your items in the compartment to keep them safe.

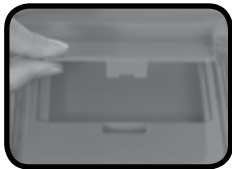

14. Pen Holder

Keep the invisible-ink pen in this holder.



ACTIVITIES

1. Start Up Tune Mode

Choose different music notes to create your own start-up tune to customize your notebook! Anytime you open your notebook, you will hear your own tune!

2. Let's Roll Mode

Listen to the 10 built-in melodies while writing your notes. You can press any button to hear different melodies.

3. Memory Chain Mode

Challenge your memory in this game. You can play this game solo, or with a friend. Will you remember the number sequence? Memorize the number sequence and repeat it!

4. Lucky Number Mode

The notebook will ask you a magic equation. When you answer it correctly, it will reveal your lucky number.

5. Fortune Tag Mode

Choose a number to receive your fortune!

CARE & MAINTENANCE

1. Keep the unit clean by wiping it with a slightly damp cloth.
2. Keep the unit out of direct sunlight and away from any direct heat source.
3. Remove the batteries if the unit will not be in use for an extended period of time.
4. Do not drop the unit on hard surfaces and do not expose the unit to moisture or water.
5. If the unit stops working or malfunctions, install a new set of batteries.

TROUBLESHOOTING

If for some reason the program/activity stops working, please follow these steps:

1. Please turn the unit **Off**.
2. Interrupt the power supply by removing the batteries.
3. Let the unit stand for a few minutes, then replace the batteries.
4. Turn the unit **On**. The unit should now be ready to play with again.
5. If the unit still does not work, install a brand new set of batteries.

NOTE

This equipment has been tested and found to comply with the limits for a Class B digital device, pursuant to Part 15 of the FCC Rules. These limits are designed to provide reasonable protection against harmful interference in a residential installation. This equipment

IMPORTANT NOTE

If the problem persists, please call our **Consumer Services Department** at **1-800-521-2010** in the U.S., **1-877-352-8697** in Canada, or visit our website **vtechkids.com** and fill out our **Contact Us** form located under the **Customer Support** link. Creating and developing VTech products is accompanied by a responsibility that we take very seriously. We make every effort to ensure the accuracy of the information, which forms the value of our products. However, errors sometimes can occur. It is important for you to know that we stand behind our products and encourage you to contact us with any problems and/or suggestions you might have. A service representative will be happy to help you.

THIS DEVICE COMPLIES WITH PART 15 OF THE FCC RULES. OPERATION IS SUBJECT TO THE FOLLOWING TWO CONDITIONS: (1) THIS DEVICE MAY NOT CAUSE HARMFUL INTERFERENCE, AND (2) THIS DEVICE MUST ACCEPT ANY INTERFERENCE RECEIVED, INCLUDING INTERFERENCE THAT MAY CAUSE UNDESIREED OPERATION.

generates, uses and can radiate radio frequency energy and, if not installed and used in accordance with the instructions, may cause harmful interference to radio communications. However, there is no guarantee that interference will not occur in a particular installation. If this equipment does cause harmful interference to radio or television reception, which can be determined by turning the equipment off and on, the user is encouraged to try to correct the interference by one or more of the following measures:

- Reorient or relocate the receiving antenna.
- Increase the separation between the equipment and receiver.
- Connect the equipment into an outlet on a circuit different from that to which the receiver is connected.
- Consult the dealer or an experienced radio/TV technician for help.

CAUTION

Changes or modifications not expressly approved by the party responsible for compliance could void the user's authority to operate the equipment.

Supplier's Declaration of Conformity

47 CFR § 2.1077 Compliance Information

Trade Name:	VTech®
Model:	5324
Product Name:	Kidi Secrets™ Doodle Pad
Responsible Party:	VTech Electronics North America, L.L.C.
Address:	1156 W. Shure Drive, Suite 200 Arlington Heights, IL 60004
Website:	vtechkids.com

**Visit our website for more
information about our products,
downloads, resources and more.**

vtechkids.com
vtechkids.ca

Read our complete warranty policy online at
vtechkids.com/warranty
vtechkids.ca/warranty



TM & © 2023 VTech Holdings Limited.
All rights reserved.
IM-532460-000
Version:0