

vtech[®]

User's Manual

Grow & Discover Music Studio™



© 2011 VTech
Printed in China
91-002587-000 (美)

Dear Parent,

*Ever notice the look on your baby's face when they learn something new through their own discovery? These self-accomplished moments are a parent's greatest reward. To help fulfill them, VTech® created the **Infant Learning**® series of toys.*

*These unique interactive learning toys directly respond to what children do naturally – play! Using innovative technology, these toys react to baby's interactions, making each play experience fun and unique as they learn age-appropriate concepts like first words, numbers, shapes, colors and music. More importantly, VTech®'s **Infant Learning**® toys develop baby's mental and physical abilities by inspiring, engaging and teaching.*

At VTech®, we know that a child has the ability to do great things. That's why all of our electronic learning products are uniquely designed to develop a child's mind and allow them to learn to the best of their ability. We thank you for trusting VTech® with the important job of helping your child learn and grow!

Sincerely,

Your friends at VTech®

*To learn more about the **Infant Learning**® series and other VTech® toys, visit www.vtechkids.com*

INTRODUCTION

Thank you for purchasing the **VTech® Grow & Discover Music Studio™** learning toy!

Get into the learning groove with the **VTech® Grow & Discover Music Studio™**! With this pretend-play music center, your baby will enjoy interacting with a variety of musical instruments that play sounds and music, in addition to teaching about numbers and shapes. The guitar and drum are detachable for on-the-go play!

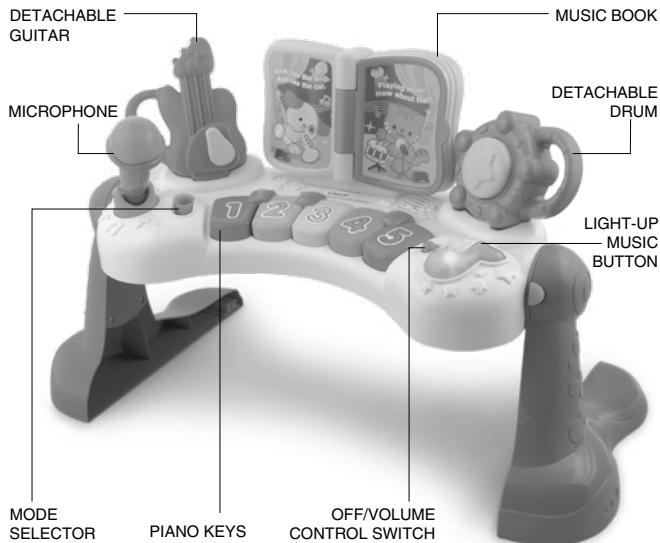

INCLUDED IN THIS PACKAGE

- One instruction manual

- One detachable guitar



- One music book



- One detachable drum

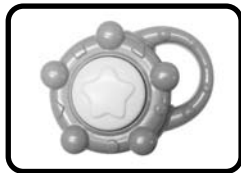

- One electronic activity panel



- Two detachable legs



WARNING:

All packing materials, such as tape, plastic sheets, packaging locks and tags are not part of this toy, and should be discarded for your child's safety.

ATTENTION:

Pour la sécurité de votre enfant, débarrassez-vous de tous les produits d'emballage tels que rubans adhésifs, feuilles de plastique, attaches et étiquettes. Ils ne font pas partie du jouet.

NOTE:

Please keep this instruction manual as it contains important information.

Unlock the packaging locks:

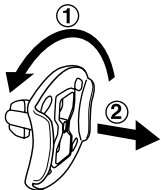

- ① Rotate the packaging locks 90 degrees counter-clockwise.
- ② Pull out the packaging locks.

Please remove and discard the try-me cable between the music book and the activity panel before assembly.



INSTRUCTIONS

BATTERY INSTALLATION

1. Make sure the unit is turned **OFF**.
2. Locate the battery cover on the back of the unit. Use a screwdriver to loosen the screw.
3. Install 3 new 'AA' (AM-3/LR6) batteries following the diagram inside the battery box. (The use of new alkaline batteries is recommended for maximum performance.)
4. Replace the battery cover and tighten the screw to secure the battery cover.

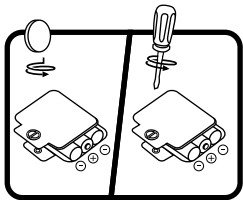

BATTERY NOTICE

- The use of new alkaline batteries is recommended for maximum performance.
- Non-rechargeable batteries are not to be recharged.
- Rechargeable batteries are to be removed from the toy before being charged (if removable).
- Rechargeable batteries are only to be charged under adult supervision (if removable).
- Do not mix old and new batteries.
- Do not mix batteries of different types: alkaline, standard (carbon-zinc) or rechargeable (nickel-cadmium).
- Only batteries of the same or equivalent type as recommended are to be used.
- Batteries are to be inserted with the correct polarity.

- Exhausted batteries are to be removed from the toy.
- The supply terminals are not to be short-circuited.
- The toy is not to be connected to more than the recommended number of power supplies.
- Do not dispose of batteries in fire.

ASSEMBLY INSTRUCTIONS

To ensure your child's safety, please only assemble this product by an adult.

1. Attach the legs one at a time by inserting the tabs on the activity panel into the holes on the legs. Push the legs until the tabs are fully inserted. You will hear a click sound when the legs are secure.



2. To remove the legs, squeeze the buttons on the sides of the legs and pull them away from the panel.

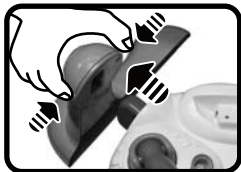

3. Attach the music book by placing it into the center of the activity panel. Press gently until you hear it click into place. Please ensure the music book is attached securely to the panel. Once it has been attached, it can not be removed again.





4. Place the guitar and drum in their respective holes on the left and right sides of the activity panel. These accessories are easily detachable for on-the-go play.



PRODUCT FEATURES

1. OFF/VOLUME CONTROL SWITCH

To turn the unit **ON**, slide the **OFF/VOLUME CONTROL SWITCH** to the **LOW VOLUME** () or **HIGH VOLUME** () position. To turn the unit **OFF**, slide the **OFF/VOLUME CONTROL SWITCH** to the **OFF** () position.



2. AUTOMATIC SHUT-OFF

To preserve battery life, the **VTech® Grow & Discover Music Studio™** will automatically power-down after approximately 30 seconds without input. The unit can be turned on again by pressing any button.

ACTIVITIES

1. Slide the **off/volume control switch** to turn on the unit. You will hear a short tune, phrase and a sing-along song. The light will flash with the sound.
2. Slide the mode selector to the **Learning Mode** (📖) or **Music Mode** position (🎵). You will hear an encouraging short tune and a sing-along song. The light will flash with the sound.
3. Press the **light-up music button** to hear a variety of melodies and sing-along songs in both modes. The light will flash with sound.
4. Press the **piano keys** to learn numbers, colors, and music notes in Learning Mode. In Music Mode, press the piano keys to play piano notes. The light will flash with the sound.

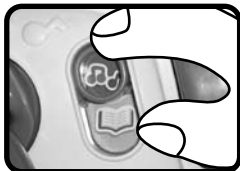

5. Attach the **guitar** and **drum** to learn their names and hear their sounds in Learning Mode. In Music Mode, attach the instruments to hear their sounds. Strum the guitar and tap on the drum when they're attached to hear their sounds. The light will flash with the sound.

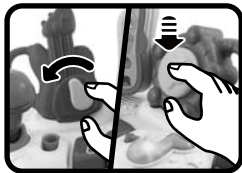

6. Turn the **music book** to learn sing-along songs and hear funny short tunes in both modes. The light will flash with the sound.



7. Sing into the **microphone** to hear your voice! The background music and other responses will become softer so that your voice is heard through the speaker.



MELODY LIST

1. Skip to My Lou
2. Pop! Goes the Weasel
3. It's Raining, It's Pouring
4. Bingo
5. Humpty Dumpty
6. Shoo, Fly

SING-ALONG SONG LYRICS

SONG 1

Sing and play, dance and sway!
Feel the beat,
Now move your feet!
You can sing and you can play,
With your microphone every day!

SONG 2

Drum, guitar and piano
Making music is simple!

SONG 3

Play the fiddle with the pig.
It's fun to have a music gig!
Grab the guitar and play along.
Use the mic to sing a song!

SONG 4

Rock like the dog,
Roll like the cat.
Playing music,
How about that?

SONG 5

Strum the guitar.
Sing like a star.
Strumming, singing,
Without ending!

CARE & MAINTENANCE

1. Keep the unit clean by wiping it with a slightly damp cloth.
2. Keep the unit out of direct sunlight and away from any direct heat source.
3. Remove the batteries when the unit will not be in use for an extended period of time.
4. Do not drop the unit on hard surfaces and do not expose the unit to moisture or water.

TROUBLESHOOTING

If for some reason the program/activity stops working or malfunctions, please follow these steps:

1. Please turn the unit **OFF**.
2. Interrupt the power supply by removing the batteries.
3. Let the unit stand for a few minutes, then replace the batteries.
4. Turn the unit **ON**. The unit should now be ready to play again.
5. If the product still does not work, replace with a new set of batteries.

If the problem persists, please call our Consumer Services Department at 1-800-521-2010 in the U.S. or 1-877-352-8697 in Canada, and a service representative will be happy to help you.

IMPORTANT NOTE:

Creating and developing **Infant Learning** products is accompanied by a responsibility that we at **VTech**® take very seriously. We make every effort to ensure the accuracy of the information, which forms the value of our products. However, errors sometimes can occur. It is important for you to know that we stand behind our products and encourage you to call our Consumer Services Department at 1-800-521-2010 in the U.S. or 1-877-352-8697 in Canada, with any problems and/or suggestions that you might have. A service representative will be happy to help you.

Note:

This equipment has been tested and found to comply with the limits for a Class B digital device, pursuant to Part 15 of the FCC Rules. These limits are designed to provide reasonable protection against harmful interference in a residential installation. This equipment generates, uses and can radiate radio frequency energy and, if not installed and used in accordance with the instructions, may cause harmful interference to radio communications. However, there is no guarantee that interference will not occur in a particular installation. If this equipment does cause harmful interference to radio or television reception, which can be determined by turning the equipment off and on, the user is encouraged to try to correct the interference by one or more of the following measures:

- Reorient or relocate the receiving antenna
- Increase the separation between the equipment and receiver
- Connect the equipment into an outlet on a circuit different from that to which the receiver is connected
- Consult the dealer or an experienced radio/TV technician for help

Caution: changes or modifications not expressly approved by the party responsible for compliance could void the user's authority to operate the equipment.

THIS DEVICE COMPLIES WITH PART 15 OF THE FCC RULES. OPERATION IS SUBJECT TO THE FOLLOWING TWO CONDITIONS:
(1) THIS DEVICE MAY NOT CAUSE HARMFUL INTERFERENCE, AND
(2) THIS DEVICE MUST ACCEPT ANY INTERFERENCE RECEIVED, INCLUDING INTERFERENCE THAT MAY CAUSE UNDESIRE OPERATION.

THIS CLASS B DIGITAL APPARATUS COMPLIES WITH CANADIAN ICES-003.

CET APPAREIL NUMÉRIQUE DE LA CLASSE B EST CONFORME À LA NORME NMB-003 DU CANADA.

