

vtech[®]

User's Manual

Play & Dream Magic Mirror™



© 2004 VTech
Printed in China

91-02108-000-000 (美)

Dear Parent,

*Ever notice the look on your baby's face when they learn something new through their own discovery? These self-accomplished moments are a parent's greatest reward. To help fulfill them, VTech® created the **Infant Learning** series of toys.*

*These unique interactive learning toys directly respond to what children do naturally – play! Using innovative technology, these toys react to baby's interactions, making each play experience fun and unique as they learn age-appropriate concepts like first words, numbers, shapes, colors and music. More importantly, VTech®'s **Infant Learning** toys develop baby's mental and physical abilities by inspiring, engaging and teaching.*

At VTech®, we know that a child has the ability to do great things. That's why all of our electronic learning products are uniquely designed to develop a child's mind and allow them to learn to the best of their ability. We thank you for trusting VTech® with the important job of helping your child learn and grow!

Sincerely,

Your Friends at VTech®

*To learn more about **Infant Learning** and other VTech® toys, visit www.vtech.com*

INTRODUCTION

Thank you for purchasing the **VTech® Play & Dream Magic Mirror™** learning toy.

The **VTech® Play & Dream Magic Mirror™** is an interactive mirror for babies birth and up. This magic mirror has two brightly colored pages where babies can learn about animals or explore their bodies. The large mirror encourages babies to discover themselves. As baby gets close to the mirror it will magically respond by asking them to pretend to be animals or look for some of their body parts. The roller, press buttons and turning page promote exploration while baby is lying in the crib, on the floor for 'tummy time' or learning to sit.

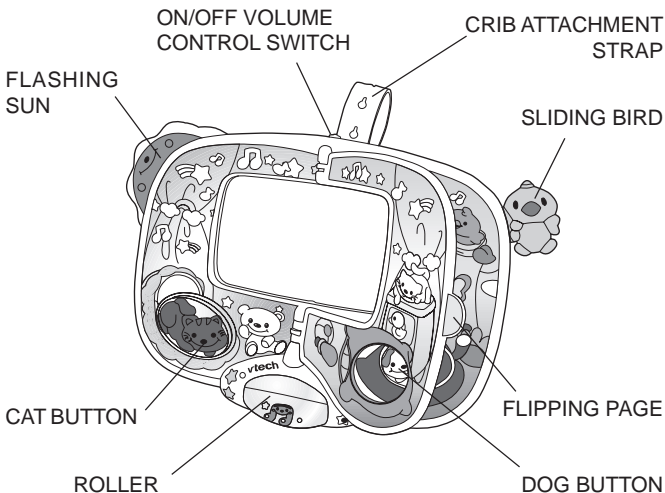

INCLUDED IN THIS PACKAGE

- One VTech® Play & Dream Magic Mirror™ learning toy
- One instruction manual
- One crib attachment strap

WARNING: All packing materials, such as tape, plastic sheets, wire ties and tags are not part of this toy, and should be discarded for your child's safety.

GETTING STARTED

BATTERY INSTALLATION

1. Make sure the unit is turned **OFF**.
2. Locate the battery cover on the back of the unit. Use a coin or a screwdriver to loosen the screw.
3. Install 3 new 'AA' (UM-3/LR6) batteries following the diagram inside the battery box. (The use of new alkaline batteries is recommended for maximum performance.)
4. Replace the battery cover and tighten the screw to secure the battery cover.

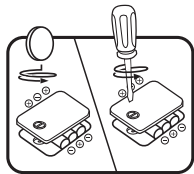



BATTERY NOTICE

- Install batteries correctly observing the polarity (+, -) signs to avoid leakage.
- Do not mix old and new batteries.
- Do not use batteries of different types.
- Remove exhausted or new batteries from the equipment when the unit will not be used for an extended period of time.
- Do not dispose of batteries in fire.
- Do not attempt to recharge ordinary batteries.
- The supply terminals are not to be short-circuited.
- Only batteries of the same and equivalent type as recommended are to be used.

WE DO NOT RECOMMEND THE USE OF RECHARGEABLE BATTERIES.

PRODUCT FEATURES

1. ON/OFF/VOLUME CONTROL SWITCH

To turn the unit **ON**, slide the **ON/OFF/VOLUME CONTROL SWITCH** to the **LOW VOLUME** () or **HIGH VOLUME** () position. To turn the unit **OFF**, slide the **ON/OFF/VOLUME CONTROL SWITCH** to the **OFF** () position.

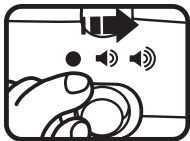

2. AUTOMATIC SHUT-OFF

To preserve battery life, the **VTech® Play & Dream Magic Mirror™** will automatically power-down after approximately 20 seconds without input. The unit can be turned on again by pressing any button. Please note the proximity sensor can only turn the unit back on within approximately three minutes of the unit powering down.

3. MODES OF PLAY

The two modes of play include a nature page and a nursery page. Turn the page to select the mode.



4. CRIB ATTACHMENT

The crib attachment strap allows for easy and secure mounting of the **VTech® Play & Dream Magic Mirror™** to a crib. To ensure your child's safety, please follow the instructions carefully and ensure the final assembly is correct. Do not attach to playpens with mesh walls.

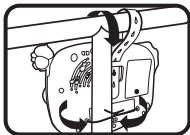

Place the unit in the crib, bringing the strap over the top rail. Slip the top of the strap under the slot on the back of the unit and secure. You can adjust the hanging height with the different holes on the top of the strap. The unit should be snug against the crib rail. Pull slightly on the unit to ensure the strap has been securely fastened. Please check frequently to ensure the unit is still secure.

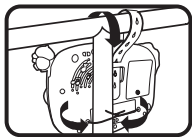

For your child's safety, please ensure that the crib attachment strap has been removed when the unit is not hanging in the crib.

5. Proximity Sensor

The activation of the sensor in the mirror will vary depending on the intensity of light. For stronger activation, please ensure the mirror is placed in a highly lit area.

ACTIVITIES

1. Slide the **on/off/volume control switch** to turn the unit on. When opened to the nature page, you will hear a song followed by chirping and barking sounds. When opened to the nursery page, you will hear "Peek-a-boo, I see you!" followed by a song. The sun will flash with the sounds.
2. Turn the page to select the mode of play.

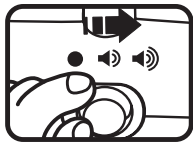

3. Press the **animal buttons** or slide the **bird** to learn about animals, animal sounds and music on the nature page or be asked to point out a variety of body parts in the nursery mode. The sun will flash with the sounds.

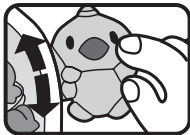

4. Spin the **roller** while on the nature page to hear a random melody with random sounds or you will hear a song or a melody played a section at a time while in the nursery mode. The sun will flash with the sounds.

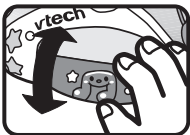

5. When baby gets close to the mirror, it will activate the proximity sensor. While on the nature page, baby can play peek-a-boo, imitate animal sounds or listen to a song. In the nursery mode, baby will be asked to look for one of their body parts or will hear a song. The sun will flash with the sounds.

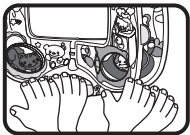

6. If there is no input to the unit after approximately ten seconds, you will hear a giggle, a phrase or a random question depending on the page that's been selected. After another ten seconds if there is still no input, the unit will automatically power-down.

MELODY LIST

Nature Page

1. Row, Row, Row Your Boat
2. Three Little Kittens
3. Sing a Song of Sixpence
4. Skip to My Lou
5. A-Tisket, A-Tasket

Nursery Page

1. Bingo
2. Pat-a-Cake
3. The Wheels on the Bus
4. Twinkle, Twinkle, Little Star
5. If You're Happy and You Know It

SUNG SONG LYRICS (to the tune of London Bridge)

A baby face is looking at me.

Ears to hear, eyes to see.

A baby face is looking at me.

Mouth to taste and nose to breathe.

CARE & MAINTENANCE

1. Keep the unit clean by wiping it with a slightly damp cloth.
2. Keep the unit out of direct sunlight and away from any direct heat source.
3. Remove the batteries when the unit is not in use for an extended period of time.
4. Do not drop the unit on hard surfaces and do not expose the unit to moisture or water.

TROUBLESHOOTING

If for some reason the program/activity stops working or malfunctions, please follow these steps:

1. Please turn the unit **OFF**.
2. Interrupt the power supply by removing the batteries.
3. Let the unit stand for a few minutes, then replace the batteries.
4. Turn the unit **ON**. The unit should now be ready to play again.

If the problem persists, please call our Consumer Services Department at 1-800-521-2010 in the U.S. or 1-877-352-8697 in Canada, and a service representative will be happy to help you.

For information on this product warranty, please call **VTech**® at 1-800-521-2010 in the U.S. or 1-877-352-8697 in Canada.

IMPORTANT NOTE:

Creating and developing **Infant Learning** products is accompanied by a responsibility that we at **VTech**[®] take very seriously. We make every effort to ensure the accuracy of the information, which forms the value of our products. However, errors sometimes can occur. It is important for you to know that we stand behind our products and encourage you to call our Consumer Services Department at 1-800-521-2010 in the U.S. or 1-877-352-8697 in Canada, with any problems and/or suggestions that you might have. A service representative will be happy to help you.

Note:

This equipment has been tested and found to comply with the limits for a Class B digital device, pursuant to Part 15 of the FCC Rules. These limits are designed to provide reasonable protection against harmful interference in a residential installation. This equipment generates, uses and can radiate radio frequency energy and, if not installed and used in accordance with the instructions, may cause harmful interference to radio communications. However, there is no guarantee that interference will not occur in a particular installation. If this equipment does cause harmful interference to radio or television reception, which can be determined by turning the equipment off and on, the user is encouraged to try to correct the interference by one or more of the following measures:

- Reorient or relocate the receiving antenna
- Increase the separation between the equipment and receiver
- Connect the equipment into an outlet on a circuit different from that to which the receiver is connected
- Consult the dealer or an experienced radio/TV technician for help